

User Instructions

Rigid-Lock QuickBerm – Plus, Rigid-Lock QuickBerm, Quick Berm with Inside Supports, Decon QuickBerm, QuickBerm Lite

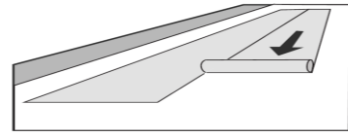

1. Choose a site which offers a level, stable surface. Carefully check the deployment area for sharp objects, stones, scrap metal, branches, construction debris and the like.



2. If ground protection, such as a tarp or ground mat, will be used in conjunction with the spill containment system it will need to be unrolled on the ground surface before deploying the berm.

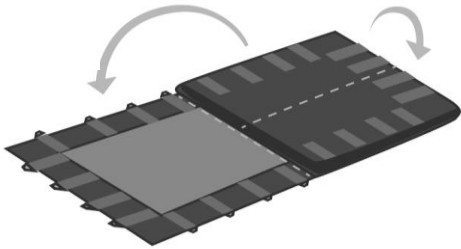

3. Unfold and squarely center the berm onto the ground protection; be sure the berm markings are facing out. Avoid dragging the berm across the ground in effort to prevent tears and wear.

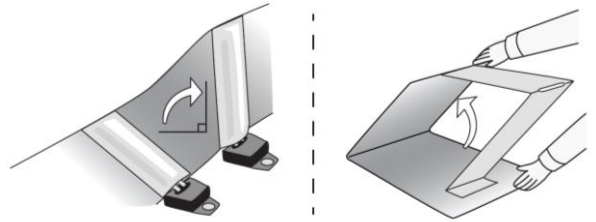

4a. Rigid-Lock QuickBerm Model Set-Up: Unfold and stand walls up locking the supports into the detent of the support.

4b. QuickBerm with Inside Supports set-up – Unfold and stand all four sides up locking the inside support by pushing the hinged part of the support down to the floor.

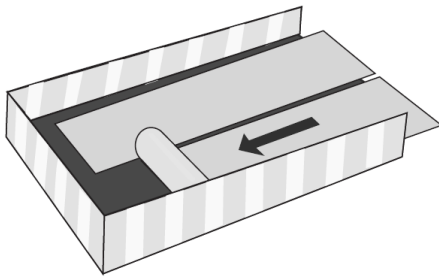

5. If runners will be used as protective barriers between tire treads and the berm floor you will need to unroll the overlay along the proposed vehicle tire path. and the berm floor.

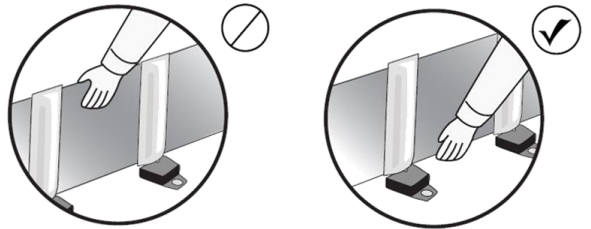

6. Always handle the berm by moving it from the bottom of the wall and not using the supports as handles. Make position adjustments by fanning the berm by the edges. Using the air beneath the containment system will reduce friction and limit abrasions.

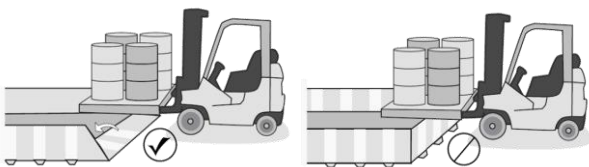

7. Before entering or exiting be sure to lower the walls in the proper direction to avoid damage to the berm.

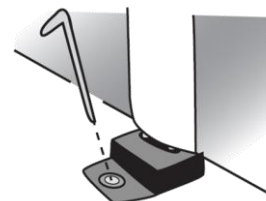

8. For outdoor use in windy conditions, use stakes through the grommets to help secure the spill containment unit to the surface. Various weight bearing methods such as sandbags and/or tie down cords can also be used for this purpose

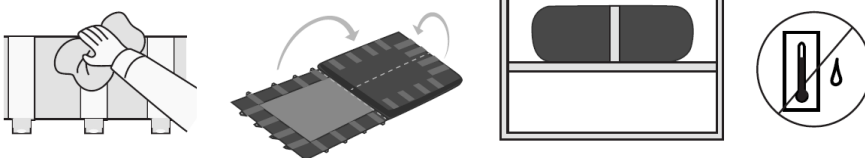

9. Thoroughly clean the spill containment unit and allow to completely dry. Fold the supports inward, toward the center of the unit before rolling or folding. Store in a cool, dry place.

Important Information:

User is responsible for checking chemical compatibility. Please consult the chemical resistance chart found at: https://www.justrite.com/media/mageplaza/product_attachments/attachment_file/jj/u/justrite-chemical-resistance-table_rev_2-19-18.pdf