

Front Opstal/Front Elevation/Frontansicht

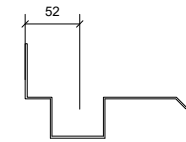

Side Opstal/Side Elevation/Seitenansicht

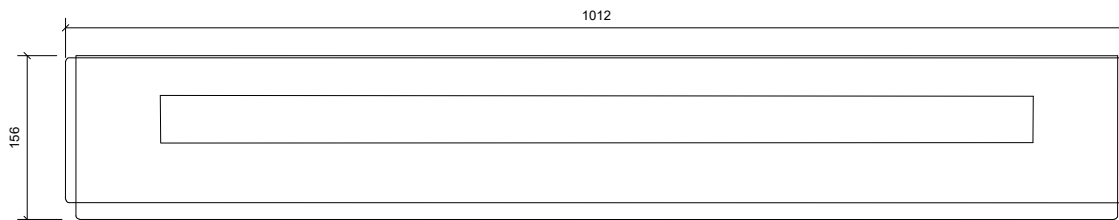

Plan/Plan/Draufsicht

### Unidrain 1000 Line

DK Afløbsarmatur | Ekstra dyb bagflange +6 mm | 900 mm  
 EN Drain unit | rear flange +6 mm | 900 mm  
 DE Ablaufarmatur | Rückflansch +6 mm | 900 mm



2020-09-08

1:5

Rev.

Art-no.

1004.0901