



DRC-LP/DTZ-LP/DFS-LP (Low Protrusion)
LED Runway Centerline, LED Touchdown Zone, Rapid Exit
Taxiway Indicator Lights (RETIL) and Enhanced Rapid Exit Taxiway
Centerline Lights

Spare Parts

SP_3061, Rev. A, 2020/05/12

**ADB
SAFEGATE**

A.0 Disclaimer / Standard Warranty

CE certification

The equipment listed as CE certified means that the product complies with the essential requirements concerning safety and hygiene. The European directives that have been taken into consideration in the design are available on written request to ADB SAFEGATE.

ETL certification

The equipment listed as ETL certified means that the product complies with the essential requirements concerning safety and FAA Airfield regulations. The FAA directives that have been taken into consideration in the design are available on written request to ADB SAFEGATE.

All Products Guarantee

ADB SAFEGATE will correct by repair or replacement per the applicable guarantee above, at its option, equipment or parts which fail because of mechanical, electrical or physical defects, provided that the goods have been properly handled and stored prior to installation, properly installed and properly operated after installation, and provided further that Buyer gives ADB SAFEGATE written notice of such defects after delivery of the goods to Buyer. Refer to the Safety section for more information on Material Handling Precautions and Storage precautions that must be followed.

ADB SAFEGATE reserves the right to examine goods upon which a claim is made. Said goods must be presented in the same condition as when the defect therein was discovered. ADB SAFEGATE further reserves the right to require the return of such goods to establish any claim.

ADB SAFEGATE's obligation under this guarantee is limited to making repair or replacement within a reasonable time after receipt of such written notice and does not include any other costs such as the cost of removal of defective part, installation of repaired product, labor or consequential damages of any kind, the exclusive remedy being to require such new parts to be furnished.

ADB SAFEGATE's liability under no circumstances will exceed the contract price of goods claimed to be defective. Any returns under this guarantee are to be on a transportation charges prepaid basis. For products not manufactured by, but sold by ADB SAFEGATE, warranty is limited to that extended by the original manufacturer. This is ADB SAFEGATE's sole guarantee and warranty with respect to the goods; there are no express warranties or warranties of fitness for any particular purpose or any implied warranties of fitness for any particular purpose or any implied warranties other than those made expressly herein. All such warranties being expressly disclaimed.

Standard Products Guarantee

Products of ADB SAFEGATE manufacture are guaranteed against mechanical, electrical, and physical defects (excluding lamps) which may occur during proper and normal use for a period of two years from the date of ex-works delivery, and are guaranteed to be merchantable and fit for the ordinary purposes for which such products are made.



Note

See your sales order contract for a complete warranty description.

FAA Certified product installed in the United States or in US Military installations guarantee

ADB SAFEGATE L858 Airfield Guidance Signs are warranted against mechanical and physical defects in design or manufacture for a period of 2 years from date of installation, per FAA AC 150/5345-44 (applicable edition).

ADB SAFEGATE L858(L) Airfield Guidance Signs are warranted against electrical defects in design or manufacture of the LED or LED specific circuitry for a period of 4 years from date of installation, per FAA EB67 (applicable edition).

ADB SAFEGATE LED light fixtures (with the exception of obstruction lighting) are warranted against electrical defects in design or manufacture of the LED or LED specific circuitry for a period of 4 years from date of installation, per FAA EB67 (applicable edition).



Note

See your sales order contract for a complete warranty description.

Liability



WARNING

Use of the equipment in ways other than described in the catalog leaflet and the manual may result in personal injury, death, or property and equipment damage. Use this equipment only as described in the manual.

ADB SAFEGATE cannot be held responsible for injuries or damages resulting from non-standard, unintended uses of its equipment. The equipment is designed and intended only for the purpose described in the manual. Uses not described in the manual are considered unintended uses and may result in serious personal injury, death or property damage.

Unintended uses, includes the following actions:

- Making changes to equipment that have not been recommended or described in this manual or using parts that are not genuine ADB SAFEGATE replacement parts or accessories.
- Failing to make sure that auxiliary equipment complies with approval agency requirements, local codes, and all applicable safety standards if not in contradiction with the general rules.
- Using materials or auxiliary equipment that are inappropriate or incompatible with your ADB SAFEGATE equipment.
- Allowing unskilled personnel to perform any task on or with the equipment.

© ADB SAFEGATE BV

This manual or parts thereof may not be reproduced, stored in a retrieval system, or transmitted, in any form or by any means, electronic, mechanical, photocopying, recording, nor otherwise, without ADB SAFEGATE BV's prior written consent.

This manual could contain technical inaccuracies or typographical errors. ADB SAFEGATE BV reserves the right to revise this manual from time to time in the contents thereof without obligation of ADB SAFEGATE BV to notify any person of such revision or change. Details and values given in this manual are average values and have been compiled with care. They are not binding, however, and ADB SAFEGATE BV disclaims any liability for damages or detriments suffered as a result of reliance on the information given herein or the use of products, processes or equipment to which this manual refers. No warranty is made that the use of the information or of the products, processes or equipment to which this manual refers will not infringe any third party's patents or rights. The information given does not release the buyer from making their own experiments and tests.

TABLE OF CONTENTS

1.0 Safety	1
1.1 Safety Messages	1
1.1.1 Introduction to Safety	2
1.1.2 Intended Use	2
1.1.3 Material Handling Precautions: Storage	3
1.1.4 Material Handling Precautions: Fasteners	3
2.0 LED Runway Centerline and Touchdown Zone In-pavement Light	5
2.1 Introduction	5
2.2 LED Runway Centerline and Touchdown Zone Inset Light	5
3.0 DRC/DTZ Parts	9
A.0 SUPPORT	15
A.1 ADB SAFEGATE Website	15
A.2 Recycling	16
A.2.1 Local Authority Recycling	16
A.2.2 ADB SAFEGATE Recycling	16

1.0 Safety

Introduction to Safety

This section contains general safety instructions for installing and using ADB SAFEGATE equipment. Some safety instructions may not apply to the equipment in this manual. Task- and equipment-specific warnings are included in other sections of this manual where appropriate.

1.1 Safety Messages

HAZARD Icons used in the manual

For all HAZARD symbols in use, see the Safety section. All symbols must comply with ISO and ANSI standards.

Carefully read and observe all safety instructions in this manual, which alert you to safety hazards and conditions that may result in personal injury, death or property and equipment damage and are accompanied by the symbol shown below.



WARNING

Failure to observe a warning may result in personal injury, death or equipment damage.



DANGER - Risk of electrical shock or ARC FLASH

Disconnect equipment from line voltage. Failure to observe this warning may result in personal injury, death, or equipment damage. ARC Flash may cause blindness, severe burns or death.



WARNING - Wear personal protective equipment

Failure to observe may result in serious injury.



WARNING - Do not touch

Failure to observe this warning may result in personal injury, death, or equipment damage.



CAUTION

Failure to observe a caution may result in equipment damage.

Qualified Personnel



Important Information

The term **qualified personnel** is defined here as individuals who thoroughly understand the equipment and its safe operation, maintenance and repair. Qualified personnel are physically capable of performing the required tasks, familiar with all relevant safety rules and regulations and have been trained to safely install, operate, maintain and repair the equipment. It is the responsibility of the company operating this equipment to ensure that its personnel meet these requirements.

Always use required personal protective equipment (PPE) and follow safe electrical work practice.

1.1.1 Introduction to Safety



CAUTION

Unsafe Equipment Use

This equipment may contain electrostatic devices, hazardous voltages and sharp edges on components

- Read installation instructions in their entirety before starting installation.
- Become familiar with the general safety instructions in this section of the manual before installing, operating, maintaining or repairing this equipment.
- Read and carefully follow the instructions throughout this manual for performing specific tasks and working with specific equipment.
- Make this manual available to personnel installing, operating, maintaining or repairing this equipment.
- Follow all applicable safety procedures required by your company, industry standards and government or other regulatory agencies.
- Install all electrical connections to local code.
- Use only electrical wire of sufficient gauge and insulation to handle the rated current demand. All wiring must meet local codes.
- Route electrical wiring along a protected path. Make sure they will not be damaged by moving equipment.
- Protect components from damage, wear, and harsh environment conditions.
- Allow ample room for maintenance, panel accessibility, and cover removal.
- Protect equipment with safety devices as specified by applicable safety regulations
- If safety devices must be removed for installation, install them immediately after the work is completed and check them for proper functioning prior to returning power to the circuit.

Failure to follow this instruction can result in serious injury or equipment damage

Additional Reference Materials



Important Information

- IEC - International Standards and Conformity Assessment for all electrical, electronic and related technologies.
- IEC 60364 - Electrical Installations in Buildings.
- FAA Advisory: AC 150/5340-26 (current edition), Maintenance of Airport Visual Aid Facilities.
- Maintenance personnel must refer to the maintenance procedure described in the ICAO Airport Services Manual, Part 9.
- ANSI/NFPA 79, Electrical Standards for Metalworking Machine Tools.
- National and local electrical codes and standards.

1.1.2 Intended Use



CAUTION

Use this equipment as intended by the manufacturer

This equipment is designed to perform a specific function, do not use this equipment for other purposes

- Using this equipment in ways other than described in this manual may result in personal injury, death or property and equipment damage. Use this equipment only as described in this manual.

Failure to follow this instruction can result in serious injury or equipment damage

1.1.3 Material Handling Precautions: Storage



CAUTION

Improper Storage

Store this equipment properly

- If equipment is to be stored prior to installation, it must be protected from the weather and kept free of condensation and dust.

Failure to follow this instruction can result in equipment damage

1.1.4 Material Handling Precautions: Fasteners



DANGER

Foreign Object Damage - FOD

This equipment may contain fasteners that may come loose - torque properly.

- Only use fasteners of the same type as the one originally supplied with the equipment.
- Use of incorrect combination of gaskets, bolts and nuts can create severe damages to the product installation and create safety risk .
- You need to know what base the light fixture will be installed in, in order to chose the correct gasket, bolts and nuts.
- Bolt type, length, and torque value are determined by type of base, height of spacers used, and clamp force required in FAA Engineering Brief No 83 (latest revision).
- Due to the risk of bolts vibrating loose, do not use any type of washer with the fixing bolts (such as split lock washers) other than an anti-vibration washer. Anti-vibration washers as defined in FAA EB 83 (latest edition) must be used. For installations other than FAA, use the base can manufacturer's recommendations.
- Always tighten the fasteners to the recommended torque. Use a calibrated torque wrench and apply the recommended adhesive type.
- Obey the instructions of the adhesives necessary for the fasteners.

Failure to follow these warnings may cause the fasteners to loosen, damage the equipment, potentially to loosen the equipment. This can lead to a highly dangerous situation of FOD, with potential lethal consequences.



Note

To minimize the risk of errors, the ADB SAFEGATE Sales Representative will have information on which gasket goes with which base. This information is also provided in the product Data sheets, the User Manuals and the Spare Part Lists.



CAUTION

Use of incorrect combination of gaskets, bolts and nuts can create severe damages to the product installation and create multiple safety risks.

To obtain a safe and watertight installation the O-ring and retaining bolt stated in the document must be used.

You need to know what base the light fixture will be installed in, in order to choose the correct gasket, bolts and nuts.

Failure to follow these cautions can result in equipment damage or aircraft FOD.

2.0 LED Runway Centerline and Touchdown Zone In-pavement Light

This user manual covers the LED In-pavement Runway Centerline and TDZ Light installation and maintenance.

2.1 Introduction

Compliance with Standards

FAA certified: Designed according to L-850A(L) and L-850B(L) AC 150/5345-46 and Engineering Brief No. 67 (Current Edition).

ICAO: Runway Centerline: Annex 14, Vol. 1, par. 5.3.12 and Appendix 2, Figure A2-7. Touchdown Zone: Annex 14, Vol. 1, par. 5.3.13 and Appendix 2, Figure A2-5.

Rapid Exit Taxiway Indicator Lights (RETIL): Annex 14, Vol. 1, par. 5.3.14 and Appendix 2, Fig. A2-7.

NATO: Compliant to STANAG 3316

T/C: Runway Centerline: Transport Canada TP 312 par. 5.3.13. Touchdown Zone: Transport Canada TP 312 par. 5.3.14.

CE: Complies with the requirements of the EMC Directive 2004/108/EC.

2.2 LED Runway Centerline and Touchdown Zone Inset Light

Compliance with Standards

ICAO:	Runway Centerline: Annex 14, Vol. 1, Ed. 6 par. 5.3.12 and Appendix 2, Figure A2-7. Touchdown Zone: Annex 14, Vol. 1, Ed. 6 par. 5.3.13 and Appendix 2, Figure A2-5. Rapid Exit Taxiway Indicator Light (RETIL): Annex 14, Vol. 1, Ed. 6 par. 15
FAA:	L- 850A(L) & L-850B(L) AC 150/5345-46 (Current Edition) and Engineering Brief No. 67. ETL Certified.
T/C:	Runway Centerline: Transport Canada TP 312 par. 5.3.13. Touchdown Zone: Transport Canada TP 312 par. 5.3.14.
NATO:	STANAG 3316

Uses

ICAO & T/C

- Runway Centerline Light in CAT I, II and III
- Touchdown Zone Light in CAT II and III
- RETIL Light on CAT I, II and III

FAA L-850A(L)

- Runway Centerline on CAT I, II, and III runways

FAA L-850B(L)

- Touchdown Zone on CAT I, II, and III runways

Features

- The evolution of the most successful LED lights in the world, fully adapted to the characteristics of an LED lighting source.
- Greatly reduced maintenance: calculated MTBF of 56,000 hours at 6.6A.
- Style 3 - Low protrusion above ground of ≤ 0.25 inch (6.3 mm) reduces vibrations caused by aircraft landing gear, increasing fixture life.
- Increased traffic efficiency and availability of the runways due to the reduction of maintenance.
- Optimum and homogeneous light distribution along the lights installed on the same runway.
- High discrimination between functions due to the saturated colors, crisp white light, their stability at the different brightness steps and under all viewing angles.

- Full compatibility with existing airfield lighting series circuits. No need to replace CCRs, series transformers, or cables.
- Fully dimmable lights, respecting the response curve of traditional halogen lights. Operates on the full range of 2.8 A to 6.6 A.
- Installation on the same bases as 8- or 12-inch tungsten-halogen lights for a straightforward replacement. Optional snow plow rings are available.
- Substantial investment reduction for new installations using smaller CCR size and series transformers, resulting from a lower installed load.
- Very low working temperature, ensuring longer component life.
- Rugged lightning protection complies with ANSI/IEEE C62.41-1991 Location Category C2 given in FAA Eng. Brief 67. Category C2 is defined as a 1.2/50 μ S – 8/20 μ S combination wave, with a peak voltage of 10,000 V and a peak current of 5,000 A.
- When turned on, light rise time is low. The light is perfectly adapted for any incursion protection system.
- Optional monitoring function of the individual light source. In case of a defect, the LED light automatically disconnects from the secondary side of the isolation transformer, resulting in an open circuit condition.
- Environment-friendly, precision-cast aluminum alloy top, intermediate and bottom covers.
- Corrosion-resistant stainless steel hardware. Use of Torx screws ensures ease of maintenance.
- For FAA applications, includes a UL 467 rated ground lug, which accepts an AWG 6 earth ground wire

DRC-LP/DTZ-LP lights are part of a complete range of LED in-pavement lights, featuring innovative characteristics, as a leverage for:

Reliability

- Additional watertightness barriers, protecting both the electronics and the LEDs in case of accidental water ingress along the prism or the gaskets as well as along the cables.
- Prisms of small dimensions installed in a deep optical channel with no negative window slope: optimal protection against rubber deposit, scratches and shocks.

Low protrusion without negative slope

- Limited height above pavement of 6.33 mm (0.25 in) reduces the risk of damage during winter operations or by towbarless tugs
- Despite the low protrusion, no part of the prism is below ground level, avoiding loss of photometry during rainfall and sedimentation on the bottom of the prism.

Maintenance friendliness

- Maintenance-friendly: components subject to wear or damage like prisms and cables can easily be replaced. Neither sealing compounds nor resin are required.
- Innovative design of the cable entry, permitting replacement without the need to open the light. This eliminates the risk of water leakage due to a pinched cable.
- Reduced number of components for maintenance simplicity.
- Pressure-release plug for water-tightness testing of fixture after overhaul.

Optional scratch-resistant prisms

- A higher hardness protective layer can be applied to the prism (see Winter Options in ordering code), making it much more resistant to scratches and sand-blasting.

Toe-in Color Coding

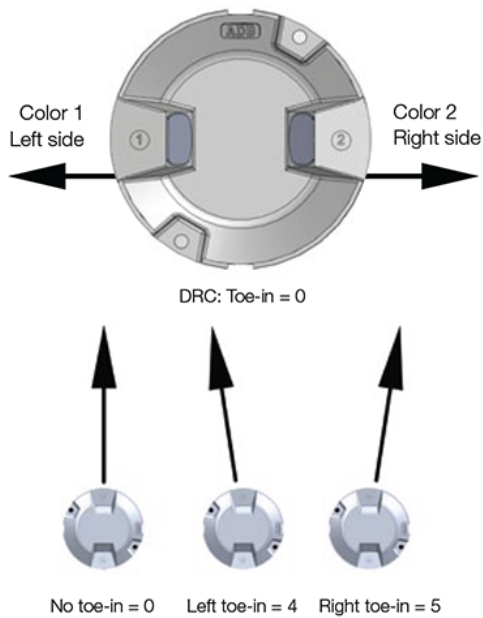

Dimensions

12" Fixture	
Outside diameter	303.3 mm / 11.94 in
Bolt-circle diameter	285.8 mm / 11.25 in
Overall height	78.4 mm / 3.1 in
8" Fixture	
Outside diameter	202 mm / 7.97 in
Bolt-circle diameter	184 mm / 7.24 in
Overall height	78.4 mm / 3.1 in
8" Shallow base	
Outside diameter	230 mm / 9.06 in
Depth	115 mm / 4.53 in

Packaging

12" Fixture	
In cardboard box	177.8 × 330 × 330 mm / 7 × 13 × 13 in
Weight with packing	5.65 kg / 12.45 lb
Weight without packing	5.1 kg / 11.25 lb
8" Fixture	

DRC-LP/DTZ-LP/DFS-LP (Low Protrusion)
LED Runway Centerline and Touchdown Zone In-pavement Light

In cardboard box	177.8 × 330 × 330 mm / 7 × 13 × 13 in
Weight with packing	3.8 kg / 8.45 lb
Weight without packing	3.3 kg / 7.25 lb
8" Fixture with Snow Plow Ring	
In cardboard box	177.8 × 330 × 330 mm / 7 × 13 × 13 in
Weight with packing	18.35 kg / 40.45 lb
Weight without packing	17.8 kg / 39.25 lb
8" Shallow Base	
In cardboard box	230 × 230 × 150 mm / 9.06 × 9.06 × 5.91 in
Weight with packing	2.8 kg / 6.17 lb
Weight without packing	2.6 kg / 5.72 lb

Power Supply

2.8A-6.6 A, through a 20/25 W isolation transformer. DRC-LP / DTZ-LP lights have been designed to work with any IEC- or FAA-compliant transformer up to 100 W without affecting the performances or the lifetime of the light or the transformer. However, using a non-matched transformer will reduce its efficiency.

See data sheet 3033 for more details on recommended isolation transformers.

DRC-LP / L-850A(L)	Fixture Load	Isolation Transformer	Isol. XF Load	CCR Load
Without Heater				
Unidirectional	15 VA	20/25 W	6 VA	21 VA
Bidirectional ¹	33 VA	30/45 W	6 VA	39 VA
Bidirectional ²	20 VA per side	20/25 W per side	6 VA per xfmr	26 VA per side
With Heater				
Unidirectional	33 VA	30/45 W	6 VA	39 VA
Bidirectional ¹	33 VA	30/45 W	6 VA	39 VA
Bidirectional ²	33 VA per side	30/45 W per side	6 VA per xfmr	39 VA per side

Notes

¹ One cord set

² One cord set per side (2 total)

DTZ-LP / L-850B(L)	Fixture Load	Isolation Transformer	Isol. XF Load	CCR Load
Without Heater				
Unidirectional	20 VA	20/25 W	6 VA	26 VA
With Heater				
Unidirectional	32 VA	30/45 W	6 VA	38 VA

3.0 DRC/DTZ Parts

Ordering Code	D	XX	XX	XX	XX	XX	XX	0	XX	XX	0
D = AD light	●										
Application RC = Runway Centerline TZ = Touchdown zone		●									
Cord Set Style and length A = Standard (Style 6 plugs), 10" long ¹ G = German Style 1 (2-pin), 10" long ¹ F = French Style 1 (3-pin), 10" long ¹ J = Style 1 (2-pin) SO jacketed cable, 18" long (FAA) ² L = Style 6 (2-pin), 18" long (FAA) ²			●								
Cable and Connector 2 = 1 plug (2-pin) 3 = 2 plugs (2-pin) 4 = 1 plug (3-pin) ⁸ 5 = 2 plugs (3-pin) ⁸				●							
LED Color 1 – Left W = White R = Red ³ N = Obscure / Blank (No light) ³ Y = Yellow ⁷					●						
LED Color 2 – Right W = White ³ R = Red ³ N = Obscure / Blank (No light)						●					
Toe-in 0 = No toe-in 4 = Left toe-in ⁴ 5 = Right toe-in ⁴							●				
Dimensions B = 8" diameter, 1/4" protrusion ⁶ D = 12" diameter, 1/4" protrusion								●			
Power Supply and Monitoring S = Current driven, 50/60Hz, w/out monitoring M = Current driven, 50/60Hz, with monitoring									●		
Standards 0 = ICAO, TP 312 and FAA										●	
Winter Options 0 = None 1 = Arctic kit 2 = Heavy-duty abrasion-resistant lens coating ⁵ 3 = Arctic kit and heavy-duty abrasion-resistant lens coating ⁵											●
Bolt Holes/Fixation Options 0 = Standard (6 bolts for 12" fixture; 2 bolts/2 fixing pins for 8" fixture) 1 = 4 bolts (8" fixtures) ⁶											●
Ground Lug Options 0 = Without ground lug ⁸ U = With UL 467 ground lug (FAA standard)											●

Ordering Code Notes

- ¹ 8" fixtures with 10" cord sets are for installation on shallow bases and are supplied with an external O-ring gasket.
- ² Fixtures with 18" cord sets are for installation on deep base cans and are not supplied with an external O-ring gasket.
- ³ Used on runway centerline applications only.
- ⁴ Used on touchdown zone applications only.
- ⁵ Typically used for intensive winter service where sand is applied to runways and rotating brushes are used.
- ⁶ Fixture can be used with an optional 12" snow plow ring adapter: Part No. AW5008ADB11E (bidirectional) or AW5008ADB1E (unidirectional).
- ⁷ To be used with RETIL applications. Not ETL Certified.
- ⁸ Not ETL Certified.

Figure 1: 12" DRC or DTZ Light Fixture Assembly

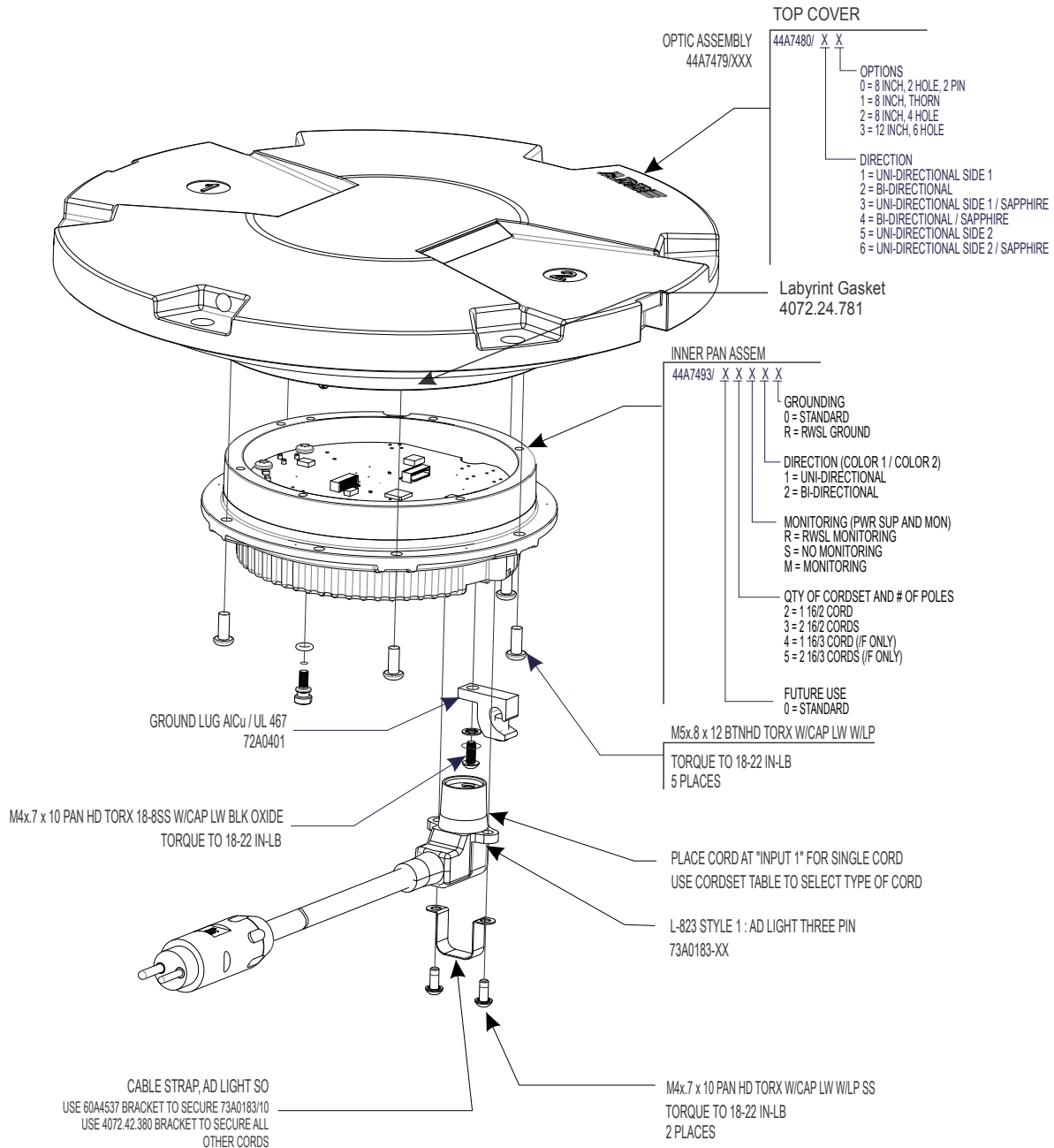
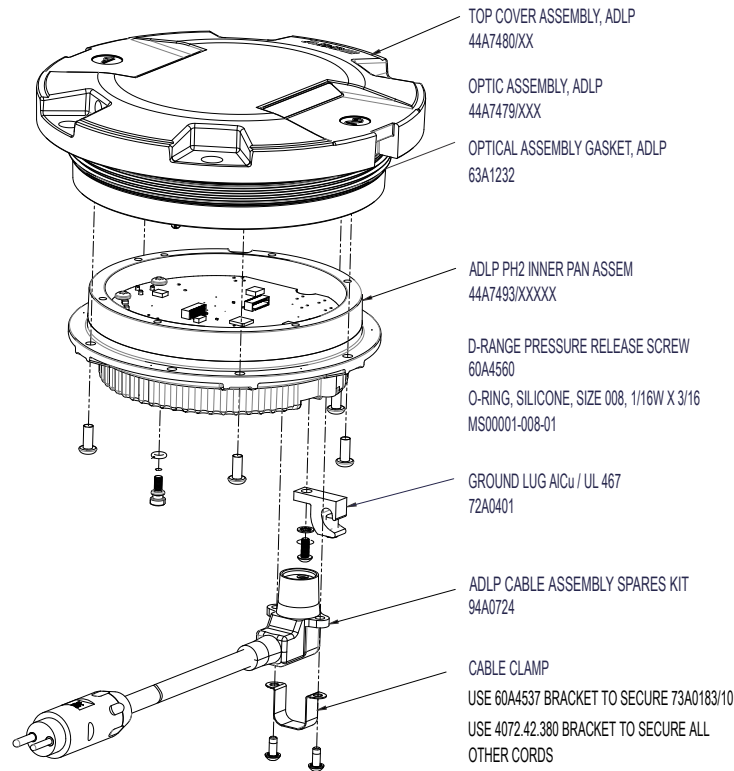

Figure 2: 8" DRC or DTZ Light Fixture Assembly



CORDSET TABLE		
LOCAL VERSION	CORDSET DESCRIPTION	PART NUMBER
A	ADB STYLE 6 WITH 10" CORD	4072.24.950
G	GERMAN (STYLE 1 PLUGS AND NAMEPLATE)	4072.24.730
F	FRENCH (3 POLE PLUGS AND PRISM PROTECTION)	4072.24.770
L	FAA (STYLE 6 PLUGS WITH 18" WIRES)	4072.42.350
J	FAA STYLE 1 SOOW JACKETED	73A0183/10

STANDARD ADLP RWSL HARDWARE SPARES KIT 94A0725 IS REQUIRED
FOR ALL SPARE REPLACEMENTS EXCEPT CABLE SPARE KIT 94A0724

Table 1: DRC-LP and DTZ-LP Light Spare Parts

Order Code	Description	DRC Monitored	DRC Unmonitored	DTZ Monitored	DTZ Unmonitored	Notes
44A7479-XXXX	LED Assembly	1	1	1	1	See Manual
44A7480-XX	Top Cover 8"	1	1	1	1	See Manual
44A7493-XXXX	ADLP Pan Assembly	1	1	1	1	See Manual
63A1232	ADLP Optical Assembly Gasket	1	1	1	1	
60A4537	ADLP SOOW Cable Clamp	1 or 2	1 or 2	1	1	FAA Jacketed Cordset Clamp
4072.42.380	ADLP Cable Clamp (non-jacketed)	1 or 2	1 or 2	1	1	Non-jacketed Cordset Clamp

Table 1: DRC-LP and DTZ-LP Light Spare Parts (continued)

Order Code	Description	DRC Monitored	DRC Unmonitored	DTZ Monitored	DTZ Unmonitored	Notes
73A0183-10	Jacketed Style 1 Cordset 18 inch (450 mm)	1 or 2	1 or 2	1	1	
4072.24.770	French Style 10" Cordset (250 mm)	1 or 2	1 or 2	1	1	
4072.24.951	Non-FAA Cordset 10" (250 mm)	1 or 2	1 or 2	1	1	
60A4560	Pressure Release Screw	1	1	1	1	
7080.90.012	O-Ring	2	2	2	2	
RWSL Kits						
44A7480/XX	Top Cover Assembly					
44A7479/XXXX	Optic Assembly					
44A7493/XXXXX	Bottom Pan Assembly					
94A0724	RWSL Cable Assembly Spares Kit					
94A0725	ADLP RWSL Hardware Spares Kit					

Figure 3: Top Cover Assembly ADLP 44A7480-XX

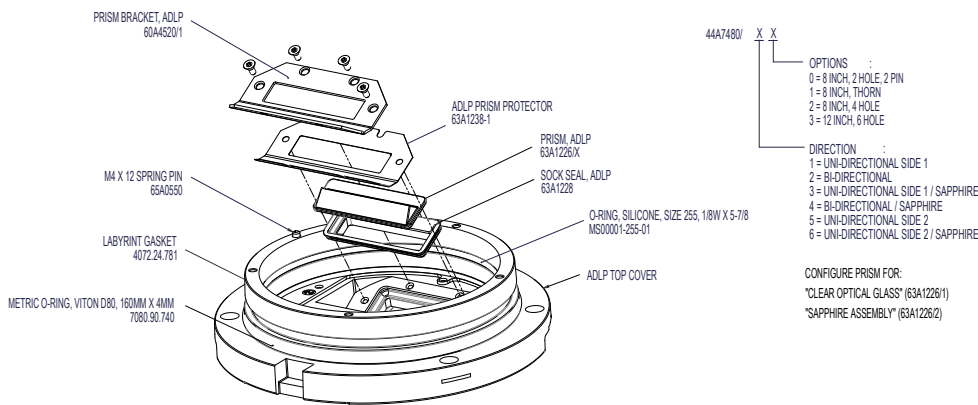
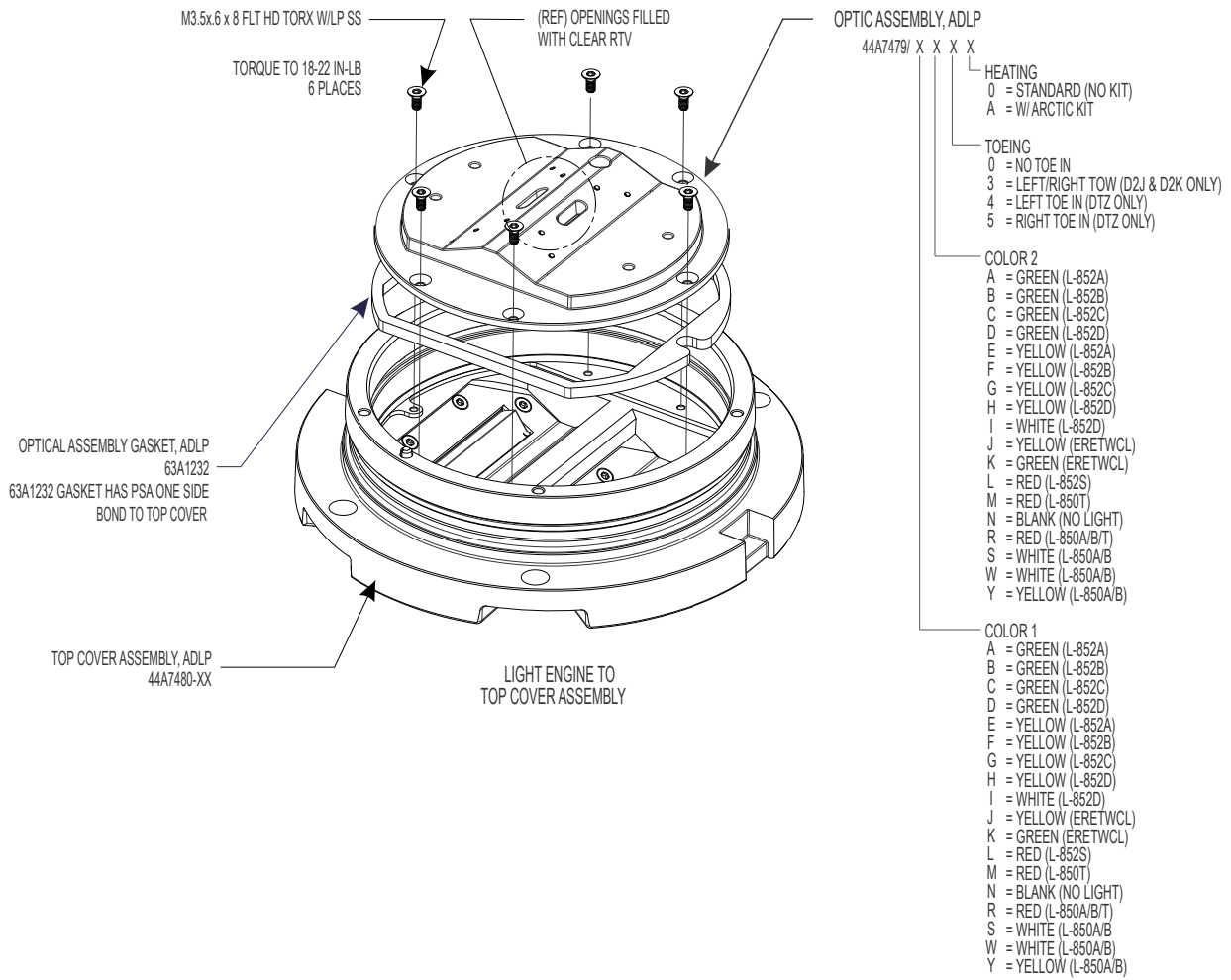

Figure 4: Light Assembly to Top CoverTI



Appendix A: SUPPORT

Our experienced engineers are available for support and service at all times, 24 hour/7 days a week. They are part of a dynamic organization making sure the entire ADB SAFEGATE is committed to minimal disturbance for airport operations.

ADB SAFEGATE Support

Live Technical Support - Americas

If at any time you have a question or concern about your product, just contact ADB SAFEGATE's technical service department. Trained in all areas of system issues, troubleshooting, quality control and technical assistance, our highly experienced Technical support specialists are available 24 hours a day, seven days a week to provide assistance over the phone.

ADB SAFEGATE **Americas Technical Service & Support (US & Canada): +1-800-545-4157**

ADB SAFEGATE Americas Technical Service & Support (International): +1-614-861-1304

During regular business hours, you can also Chat with a Service Technician. We look forward to working with you!

Before You Call

When you have an airfield lighting or system control system problem it is our goal to support airfield maintenance staff as quickly as possible. To support this effort we ask that you have the following information ready before calling.

- The *airport code*
- If not with an airport, then company name (prefer customer id number)
- Contact phone number and email address
- Product with part number preferable or product number
- Have you reviewed the product's manual and troubleshooting guide
- Do you have a *True RMS* meter available (and any other necessary tools)
- Be located with the product ready to troubleshoot

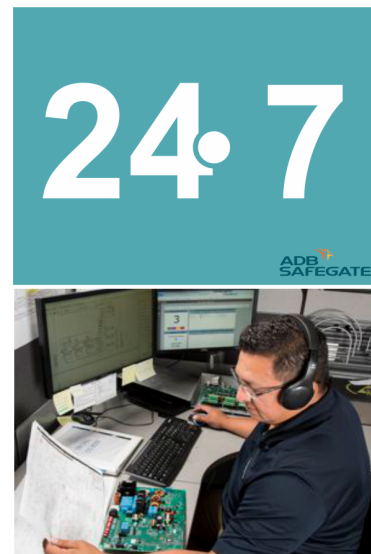

Note

For more information, see www.adbsafegate.com, or contact ADB SAFEGATE Support via email at support@adbsafegate.com or

Brussels: +32 2 722 17 11

Rest of Europe: +46 (0) 40 699 17 40

Americas: +1 614 861 1304. Press 3 for technical service or press 4 for sales support.

China: +86 (10) 8476 0106

A.1 ADB SAFEGATE Website

The ADB SAFEGATE website, www.adbsafegate.com, offers information regarding our airport solutions, products, company, news, links, downloads, references, contacts and more.

A.2 Recycling

A.2.1 Local Authority Recycling

The disposal of ADB SAFEGATE products is to be made at an applicable collection point for the recycling of electrical and electronic equipment. The correct disposal of equipment prevents any potential negative consequences for the environment and human health, which could otherwise be caused by inappropriate waste handling. The recycling of materials helps to conserve natural resources. For more detailed information about recycling of products, contact your local authority city office.

A.2.2 ADB SAFEGATE Recycling

ADB SAFEGATE is fully committed to environmentally-conscious manufacturing with strict monitoring of our own processes as well as supplier components and sub-contractor operations. ADB SAFEGATE offers a recycling program for our products to all customers worldwide, whether or not the products were sold within the EU.

ADB SAFEGATE products and/or specific electrical and electronic component parts which are fully removed/separated from any customer equipment and returned will be accepted for our recycling program.

All items returned must be clearly labelled as follows:

- For *ROHS/WEEE* Recycling
- Sender contact information (Name, Business Address, Phone number).
- Main Unit Serial Number.

ADB SAFEGATE will continue to monitor and update according for any future requirements for *EU directives* as and when *EU member states* implement new *regulations* and or *amendments*. It is our aim to maintain our *compliance plan* and assist our customers.

Company Addresses

ADB SAFEGATE	ADB SAFEGATE, Belgium: Leuvensesteenweg 585, B-1930 Zaventem Belgium
Contact: Tel.: +32 2 722 17 11, Fax: +32 2 722 17 64	Email: marketing@adbsafegate.com Internet: www.adbsafegate.com
Americas LLC	ADB SAFEGATE, Americas: 977 Gahanna Parkway, Columbus, OH 43230 USA
Contact: Tel.: +1 (614) 861 1304, Fax: +1 (614) 864 2069	Email: sales.us@adbsafegate.com Internet: www.adbsafegate.com
ADB SAFEGATE Sweden AB	ADB SAFEGATE, Sweden: Djurhagegatan 19 SE-213 76 Malmö Sweden
Contact: Tel.: +46 (0)40 699 17 00, Fax: +46 (0)40 699 17 30	Email: marketing@adbsafegate.com Internet: www.adbsafegate.com
ADB SAFEGATE Airfield Technologies Ltd. China	ADB SAFEGATE, China: Unit 603, D Block, CAMIC International Convention Center, No 3, Hua Jia Di East road, ChaoYang district, Beijing 100102 P.R. China
Contact: Tel.: +86 (10) 8476 0106, Fax: +86 (10) 8476 0090	Email: china@safegate.com Internet: www.adbsafegate.com
ADB SAFEGATE Germany GmbH	ADB SAFEGATE Germany GmbH, Mannheim: Konrad-Zuse-Ring 6, D-68163 Mannheim Germany
Contact: Tel.: +49 (621) 87 55 76-0, Fax: +49 (621) 87 55 76-55	Email: marketing@adbsafegate.com Internet: www.adbsafegate.com



Powering Your Airport Performance from Approach to Departure

adbsafegate.com

Copyright © ADB SAFEGATE, all rights reserved

