



IREL In-pavement Runway Edge Light Type L-850C, Style 3

Spare Parts

SP_2036, Rev. A, 2020/04/29

**ADB
SAFEGATE**

A.0 Disclaimer / Standard Warranty

CE certification

The equipment listed as CE certified means that the product complies with the essential requirements concerning safety and hygiene. The European directives that have been taken into consideration in the design are available on written request to ADB SAFEGATE.

ETL certification

The equipment listed as ETL certified means that the product complies with the essential requirements concerning safety and FAA Airfield regulations. The FAA directives that have been taken into consideration in the design are available on written request to ADB SAFEGATE.

All Products Guarantee

ADB SAFEGATE will correct by repair or replacement per the applicable guarantee above, at its option, equipment or parts which fail because of mechanical, electrical or physical defects, provided that the goods have been properly handled and stored prior to installation, properly installed and properly operated after installation, and provided further that Buyer gives ADB SAFEGATE written notice of such defects after delivery of the goods to Buyer. Refer to the Safety section for more information on Material Handling Precautions and Storage precautions that must be followed.

ADB SAFEGATE reserves the right to examine goods upon which a claim is made. Said goods must be presented in the same condition as when the defect therein was discovered. ADB SAFEGATE further reserves the right to require the return of such goods to establish any claim.

ADB SAFEGATE's obligation under this guarantee is limited to making repair or replacement within a reasonable time after receipt of such written notice and does not include any other costs such as the cost of removal of defective part, installation of repaired product, labor or consequential damages of any kind, the exclusive remedy being to require such new parts to be furnished.

ADB SAFEGATE's liability under no circumstances will exceed the contract price of goods claimed to be defective. Any returns under this guarantee are to be on a transportation charges prepaid basis. For products not manufactured by, but sold by ADB SAFEGATE, warranty is limited to that extended by the original manufacturer. This is ADB SAFEGATE's sole guarantee and warranty with respect to the goods; there are no express warranties or warranties of fitness for any particular purpose or any implied warranties of fitness for any particular purpose or any implied warranties other than those made expressly herein. All such warranties being expressly disclaimed.

Standard Products Guarantee

Products of ADB SAFEGATE manufacture are guaranteed against mechanical, electrical, and physical defects (excluding lamps) which may occur during proper and normal use for a period of two years from the date of ex-works delivery, and are guaranteed to be merchantable and fit for the ordinary purposes for which such products are made.



Note

See your sales order contract for a complete warranty description.

FAA Certified product installed in the United States or in US Military installations guarantee

ADB SAFEGATE L858 Airfield Guidance Signs are warranted against mechanical and physical defects in design or manufacture for a period of 2 years from date of installation, per FAA AC 150/5345-44 (applicable edition).

ADB SAFEGATE L858(L) Airfield Guidance Signs are warranted against electrical defects in design or manufacture of the LED or LED specific circuitry for a period of 4 years from date of installation, per FAA EB67 (applicable edition).

ADB SAFEGATE LED light fixtures (with the exception of obstruction lighting) are warranted against electrical defects in design or manufacture of the LED or LED specific circuitry for a period of 4 years from date of installation, per FAA EB67 (applicable edition).



Note

See your sales order contract for a complete warranty description.

Liability



WARNING

Use of the equipment in ways other than described in the catalog leaflet and the manual may result in personal injury, death, or property and equipment damage. Use this equipment only as described in the manual.

ADB SAFEGATE cannot be held responsible for injuries or damages resulting from non-standard, unintended uses of its equipment. The equipment is designed and intended only for the purpose described in the manual. Uses not described in the manual are considered unintended uses and may result in serious personal injury, death or property damage.

Unintended uses, includes the following actions:

- Making changes to equipment that have not been recommended or described in this manual or using parts that are not genuine ADB SAFEGATE replacement parts or accessories.
- Failing to make sure that auxiliary equipment complies with approval agency requirements, local codes, and all applicable safety standards if not in contradiction with the general rules.
- Using materials or auxiliary equipment that are inappropriate or incompatible with your ADB SAFEGATE equipment.
- Allowing unskilled personnel to perform any task on or with the equipment.

© ADB SAFEGATE BV

This manual or parts thereof may not be reproduced, stored in a retrieval system, or transmitted, in any form or by any means, electronic, mechanical, photocopying, recording, nor otherwise, without ADB SAFEGATE BV's prior written consent.

This manual could contain technical inaccuracies or typographical errors. ADB SAFEGATE BV reserves the right to revise this manual from time to time in the contents thereof without obligation of ADB SAFEGATE BV to notify any person of such revision or change. Details and values given in this manual are average values and have been compiled with care. They are not binding, however, and ADB SAFEGATE BV disclaims any liability for damages or detriments suffered as a result of reliance on the information given herein or the use of products, processes or equipment to which this manual refers. No warranty is made that the use of the information or of the products, processes or equipment to which this manual refers will not infringe any third party's patents or rights. The information given does not release the buyer from making their own experiments and tests.

TABLE OF CONTENTS

1.0 Safety	1
1.1 Safety Messages	1
1.1.1 Introduction to Safety	2
1.1.2 Intended Use	2
1.1.3 Material Handling Precautions: Storage	3
2.0 IREL L-850C Description	5
2.1 Introduction	5
2.2 In-pavement Runway Edge Light	6
3.0 Parts	7
3.1 Introduction	7
3.2 F-Range L-850C Light Fixture Parts List	7
3.3 F-Range Optical Unit Parts List	10
3.4 Recommended Spare Parts	11
A.0 SUPPORT	13
A.1 ADB SAFEGATE Website	13
A.2 Recycling	14
A.2.1 Local Authority Recycling	14
A.2.2 ADB SAFEGATE Recycling	14

List of Figures

Figure 1: Top View of L-850C Style 3 F-Range Inset Light Fixture	5
Figure 2: Cutaway View of L-850C F-Range Inset Light Fixture	5
Figure 3: Figure 7-2 F-Range L-850C Light Fixture (1 of 3)	9
Figure 4: Figure 7-2. F-Range L-850C Light Fixture (2 of 3)	10
Figure 5: Figure 7-2. F-Range L-850C Light Fixture (3 of 3)	10

1.0 Safety

Introduction to Safety





This section contains general safety instructions for installing and using ADB SAFEGATE equipment. Some safety instructions may not apply to the equipment in this manual. Task- and equipment-specific warnings are included in other sections of this manual where appropriate.

1.1 Safety Messages

HAZARD Icons used in the manual

For all HAZARD symbols in use, see the Safety section. All symbols must comply with ISO and ANSI standards.

Carefully read and observe all safety instructions in this manual, which alert you to safety hazards and conditions that may result in personal injury, death or property and equipment damage and are accompanied by the symbol shown below.

	WARNING Failure to observe a warning may result in personal injury, death or equipment damage.
	DANGER - Risk of electrical shock or ARC FLASH Disconnect equipment from line voltage. Failure to observe this warning may result in personal injury, death, or equipment damage. ARC Flash may cause blindness, severe burns or death.
	WARNING - Wear personal protective equipment Failure to observe may result in serious injury.
	WARNING - Do not touch Failure to observe this warning may result in personal injury, death, or equipment damage.
	CAUTION Failure to observe a caution may result in equipment damage.

Qualified Personnel

	Important Information The term qualified personnel is defined here as individuals who thoroughly understand the equipment and its safe operation, maintenance and repair. Qualified personnel are physically capable of performing the required tasks, familiar with all relevant safety rules and regulations and have been trained to safely install, operate, maintain and repair the equipment. It is the responsibility of the company operating this equipment to ensure that its personnel meet these requirements. Always use required personal protective equipment (PPE) and follow safe electrical work practice.
---	--

1.1.1 Introduction to Safety



CAUTION

Unsafe Equipment Use

This equipment may contain electrostatic devices, hazardous voltages and sharp edges on components

- Read installation instructions in their entirety before starting installation.
- Become familiar with the general safety instructions in this section of the manual before installing, operating, maintaining or repairing this equipment.
- Read and carefully follow the instructions throughout this manual for performing specific tasks and working with specific equipment.
- Make this manual available to personnel installing, operating, maintaining or repairing this equipment.
- Follow all applicable safety procedures required by your company, industry standards and government or other regulatory agencies.
- Install all electrical connections to local code.
- Use only electrical wire of sufficient gauge and insulation to handle the rated current demand. All wiring must meet local codes.
- Route electrical wiring along a protected path. Make sure they will not be damaged by moving equipment.
- Protect components from damage, wear, and harsh environment conditions.
- Allow ample room for maintenance, panel accessibility, and cover removal.
- Protect equipment with safety devices as specified by applicable safety regulations
- If safety devices must be removed for installation, install them immediately after the work is completed and check them for proper functioning prior to returning power to the circuit.

Failure to follow this instruction can result in serious injury or equipment damage

Additional Reference Materials



Important Information

- IEC - International Standards and Conformity Assessment for all electrical, electronic and related technologies.
- IEC 60364 - Electrical Installations in Buildings.
- FAA Advisory: AC 150/5340-26 (current edition), Maintenance of Airport Visual Aid Facilities.
- Maintenance personnel must refer to the maintenance procedure described in the ICAO Airport Services Manual, Part 9.
- ANSI/NFPA 79, Electrical Standards for Metalworking Machine Tools.
- National and local electrical codes and standards.

1.1.2 Intended Use



CAUTION

Use this equipment as intended by the manufacturer

This equipment is designed to perform a specific function, do not use this equipment for other purposes

- Using this equipment in ways other than described in this manual may result in personal injury, death or property and equipment damage. Use this equipment only as described in this manual.

Failure to follow this instruction can result in serious injury or equipment damage

1.1.3 Material Handling Precautions: Storage



CAUTION

Improper Storage

Store this equipment properly

- If equipment is to be stored prior to installation, it must be protected from the weather and kept free of condensation and dust.

Failure to follow this instruction can result in equipment damage

2.0 IREL L-850C Description

2.1 Introduction

This section describes the ADB SAFEGATE F-Range Type L-850C, Style 3 inset lights.

See [Figure 1](#) and [Figure 2](#). The 12-inch L-850C F-Range inset light fixtures are designed to mark the runway edge. It is manufactured in accordance with FAA specification AC 150/5345-46B, Style 3 (± 0.25 inches Height Above Grade).

Figure 1: Top View of L-850C Style 3 F-Range Inset Light Fixture



Figure 2: Cutaway View of L-850C F-Range Inset Light Fixture

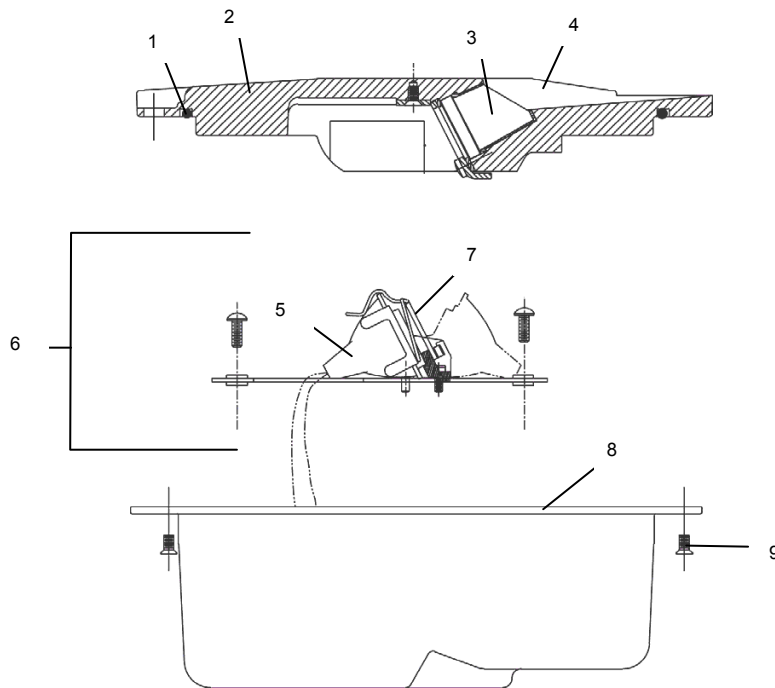

1. O-Ring	4. Light Channel	7. Lamp and Filter Holder Assembly
2. Top Cover	5. Lamp	8. Inner Cover
3. Prism	6. Optical Unit	9. Phillips Flat Head Screw

2.2 In-pavement Runway Edge Light

Compliance with Standards

FAA:	L-850C AC 150/5345-46 (Current Edition). ETL Certified.
Military:	Photometry complies with UFC 3-535-01 Fig. 4-2.

Uses

- FAA L-850C**
- Runway edge on category I, II, and III runways
 - Military runway edge applications less than 200 feet wide

Features

- Light channel in front of prism windows protects prisms from damage and prevents rubber buildup thereby maintaining optimal light output
- Low-energy/long-life halogen lamps are 105 W with a rated life of 1,000 hours at 6.6 A
- Low-temperature lights. Temperature rise at center of top cover remains below FAA-specified limit of 320 °F (160 °C).
- Fixture uses aluminum alloy cover, stainless steel hardware, and aluminum alloy and stainless steel optical assembly
- Includes a UL 467 rated ground lug, which accepts an AWG 6 earth ground wire

Dimensions

Outside Diameter:	11.94 in / 30.33 cm
Bolt Circle Diameter (L-868B):	11.25 in / 28.58 cm
Max. Bottom Cover O.D.:	9.94 in / 25.25 cm
Bottom Cover Depth:	3.8 in / 9.65 cm ¹

Notes

¹ If used in conjunction with an L-868B Top Section, the overall height of the Top Section must be 4 in (10.16 cm) minimum.

Packaging

In cardboard box:	7 × 13 × 13 in / 17.8 × 33 × 33 cm
Weight - with packing:	15.3 lb / 6.94 kg
Weight - without packing:	12.3 lb / 5.58 kg

Optional Snow Plow Ring

Depending on installation method and snow plowing technique used, a snow plow ring may be necessary. Snow plow rings are available for either standard or stainless steel adjustable Size B L-868 cans. Contact ADB SAFEGATE Sales for additional details.

3.0 Parts

3.1 Introduction

To order parts, call ADB SAFEGATE Customer Service or your local representative. Use this four-column parts list, and the accompanying illustration, to describe and locate parts correctly.

Ordering Code

44A6009 - X X X X

Left Filter Colors¹

- 0 = White (No Filter)
- 1 = Yellow
- 2 = Red
- 3 = Obscured

Right Filter Colors²

- 0 = White (No Filter)
- 1 = Yellow
- 2 = Red
- 3 = Obscured

Film Disc Cutout

- 1 = Included
- 2 = Not Included

Cord Sets

- 1 = One L-823 Cord Set
- 2 = Two L-823 Cord Sets

Notes

Bidirectional fixture uses two 105 W lamps and unidirectional fixture uses one 105 W lamp.

^{1,2} See filter location diagram below.

Toe-in Coding

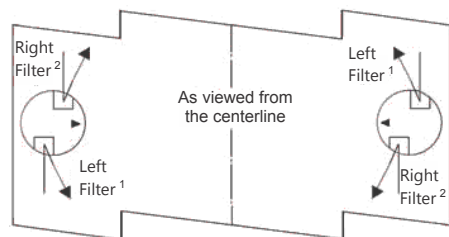

Note: Triangle embossed on the top cover should point toward the centerline to ensure correct toe-in position.

3.2 F-Range L-850C Light Fixture Parts List

See [Figure 3](#).

Part Number	Description	Quantity	Note
44A6017	Top cover	1	
44A6017-1	Top cover, right window, unidirectional		
44A6017-2	Top cover, bidirectional		
44A6017-2	Top cover, left window unidirectional		
44A6018	Optical unit	1	
44A6018-1	Optical unit, 1 lamp, right hand		
44A6018-2	Optical unit, 1 lamp, left hand		
44A6018-3	Optical unit, 2 lamps		

IREL In-pavement Runway Edge Light
Parts

Part Number	Description	Quantity	Note
44A6019	Inner pan assembly	1	
44A6019-1	Inner pan assembly, 2 lamp, 1 cordset, without film disc cutout		
44A6019-2	Inner pan assembly, 2 lamp, 1 cordset, with film disc cutout		
44A6019-3	Inner pan assembly, 2 lamp, 2 cordset, without film disc cutout		
44A6019-4	Inner pan assembly, 2 lamp, 1 cordset, with film disc cutout		
44A6019-5	Inner pan assembly, left-hand lamp, 1 cordset, without film disc cutout		
44A6019-6	Inner pan assembly, left-hand lamp, 1 cordset, with film disc cutout		
44A6019-7	Inner pan assembly, right-hand lamp, 1 cordset, without film disc cutout		
44A6019-8	Inner pan assembly, right-hand lamp, 1 cordset, with film disc cutout		
44A6112	Terminal block assembly	See note.	A
44A6112-1	Terminal block assembly, without film disc cutout		
44A6112-2	Terminal block assembly, with film disc cutout		
47A0118	Film disc cutout	See note.	A
60A2602	Pressure release screw	1	
60A2603	Optical bracket	1	
63A0222	Grommet (for optical bracket)	3	
63A0964	Filter, yellow	See note.	B
63A0986	Flat seal	See note.	A
63A0993-3	Prism	See note.	A
63B0267-011	O-ring, pressure screw	1	
64A0925-10	Screw, M5 x 10		
	Screw, M5 x 10 (for top cover assembly)	See note.	A
	Screw, M5 x 10 (to connect top cover assembly to innerpan assembly)	10	
64A0936-13	Screw, M5 x 13 (for top cover assembly)	See note.	A
73A0133-31	Cordset	1	
1411.22.001	Lamp and filter holder assembly – New Style used on fixtures purchased after 9/20/05, See Fig 6-8, Item 8	See note.	A
1411.22.002	Lamp and filter holder assembly – Old Style used on fixtures purchased before 9/20/05, See Fig 6-6, Item 10	See Note	A
2990.40.900	Lamp, 105 W	See note.	A
4017.50.130	Film disc cutout clip	See note.	A
4071.50.030	Sock seal	See note.	A
4071.50.052	Prism keeper plate	See note.	A
4071.50.090	Wire clamp (for cordset)	1	
4071.50.160	Filter spring	1	
4017.50.360	Prism clamp	See note.	A
4071.58.510	Retainer spring	See note.	A
4071.62.630	Inner cover	1	

Part Number	Description	Quantity	Note
6111.87.140	Fast-on connector (for inner pan terminal block)	See note.	B
6126.01.031	Grommets (for cordset)	2	
MS00001-376-01	O-ring (for top cover)	1	



Note

A: Quantity is 1 for unidirectional, 2 for bidirectional.



Note

B: Quantity is 1 for clear/yellow lens, 0 for clear/clear lens. The white lens has no filter.

Figure 3: Figure 7-2 F-Range L-850C Light Fixture (1 of 3)

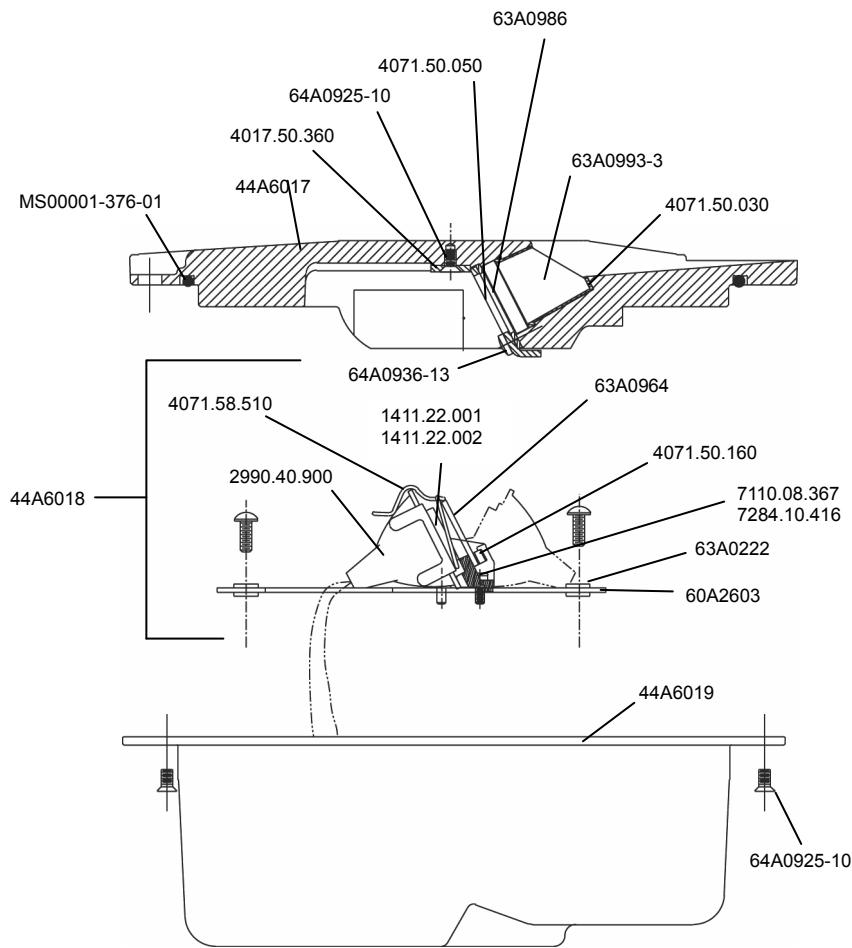

Figure 4: Figure 7-2. F-Range L-850C Light Fixture (2 of 3)

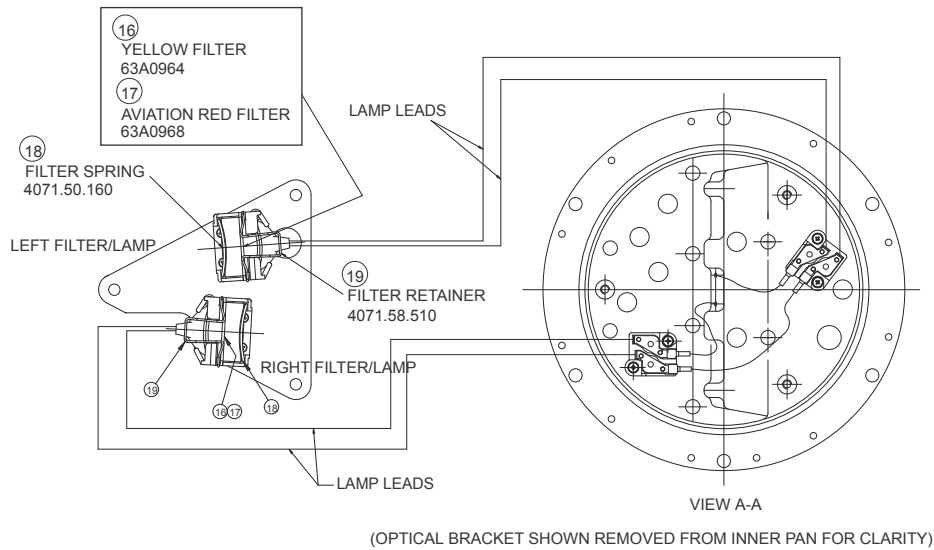
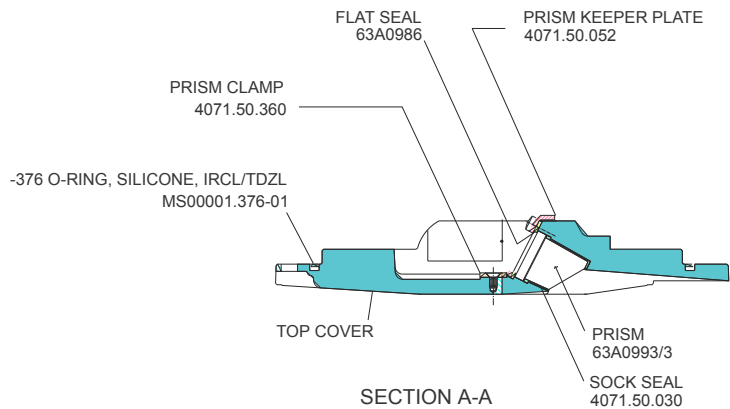

Figure 5: Figure 7-2. F-Range L-850C Light Fixture (3 of 3)



3.3 F-Range Optical Unit Parts List

See Figure 7-2.

Part Number	Description	Quantity	Note
44A6018	Optical unit	1	
44A6018-1	Optical unit, 1 lamp, right hand		
44A6018-2	Optical unit, 1 lamp, left hand		
44A6018-3	Optical unit, 2 lamps		
60A2603	Optical bracket	1	
63A0222	Grommet (for optical bracket)	3	
1411.22.001	Lamp and filter holder assembly – New Style used on fixtures purchased after 9/20/05, See Fig 6-8, Item 8	See note.	A,
1411.22.002	Lamp and filter holder assembly – Old Style used on fixtures purchased before 9/20/05, See Fig 6-6, Item 10	See note	A
2990.40.900	Lamp, 105 W	See note.	A

Part Number	Description	Quantity	Note
7110.08.367	Screw, M4 x 10 (for optical unit)	See note.	A
7284.10.416	Spring lockwasher, M4	See note.	B



Note

A: Quantity is 1 for unidirectional, 2 for bidirectional.



Note

B: Quantity is 2 for unidirectional, 4 for bidirectional.

3.4 Recommended Spare Parts

See Figure 7-2.

Part Number	Description
44A6017-X	Top cover
44A6017-1	Top cover, right window, unidirectional
44A6017-2	Top cover, bidirectional
44A6017-2	Top cover, left window unidirectional
44A6018-X	Optical unit
44A6018-1	Optical unit, 1 lamp, right hand
44A6018-2	Optical unit, 1 lamp, left hand
44A6018-3	Optical unit, 2 lamps
44A6019-X	Inner pan assembly
44A6019-1	Inner pan assembly, 2 lamp, 1 cordset, without film disc cutout
44A6019-2	Inner pan assembly, 2 lamp, 1 cordset, with film disc cutout
44A6019-3	Inner pan assembly, 2 lamp, 2 cordset, without film disc cutout
44A6019-4	Inner pan assembly, 2 lamp, 1 cordset, with film disc cutout
44A6019-5	Inner pan assembly, left-hand lamp, 1 cordset, without film disc cutout
44A6019-6	Inner pan assembly, left-hand lamp, 1 cordset, with film disc cutout
44A6019-7	Inner pan assembly, right-hand lamp, 1 cordset, without film disc cutout
44A6019-8	Inner pan assembly, right-hand lamp, 1 cordset, with film disc cutout
44A6112-X	Terminal block assembly
44A6112-1	Terminal block assembly, without film disc cutout
44A6112-2	Terminal block assembly, with film disc cutout
47A0118	Film disc cutout
60A2602	Pressure release screw
60A2603	Optical bracket
63A0222	Grommet (for optical bracket)
63A0964	Filter, yellow
63A0986	Flat seal
63A0993-3	Prism

IREL In-pavement Runway Edge Light
Parts

63B0267-011	O-ring, pressure screw
67A0095	Molykote lubricate
73A0133-31	Cordset
1411.22.001	Lamp and filter holder assembly
2990.40.900	Lamp, 105 W
4017.50.130	Film disc cutout clip
4071.50.030	Sock seal
4071.50.052	Prism keeper plate
4071.50.090	Wire clamp (for cordset)
4071.50.160	Filter spring
4017.50.360	Prism clamp
4071.58.510	Retainer spring
4071.62.630	Inner cover
6111.87.140	Fast-on connector (for inner pan terminal block)
6126.01.031	Grommets (for cordset)
MS00001-376-01	O-ring (for top cover)

Appendix A: SUPPORT

Our experienced engineers are available for support and service at all times, 24 hour/7 days a week. They are part of a dynamic organization making sure the entire ADB SAFEGATE is committed to minimal disturbance for airport operations.

ADB SAFEGATE Support

Live Technical Support - Americas

If at any time you have a question or concern about your product, just contact ADB SAFEGATE's technical service department. Trained in all areas of system issues, troubleshooting, quality control and technical assistance, our highly experienced Technical support specialists are available 24 hours a day, seven days a week to provide assistance over the phone.

ADB SAFEGATE Americas Technical Service & Support (US & Canada): +1-800-545-4157

ADB SAFEGATE Americas Technical Service & Support (International): +1-614-861-1304

During regular business hours, you can also Chat with a Service Technician. We look forward to working with you!

Before You Call

When you have an airfield lighting or system control system problem it is our goal to support airfield maintenance staff as quickly as possible. To support this effort we ask that you have the following information ready before calling.

- The *airport code*
- If not with an airport, then company name (prefer customer id number)
- Contact phone number and email address
- Product with part number preferable or product number
- Have you reviewed the product's manual and troubleshooting guide
- Do you have a *True RMS* meter available (and any other necessary tools)
- Be located with the product ready to troubleshoot

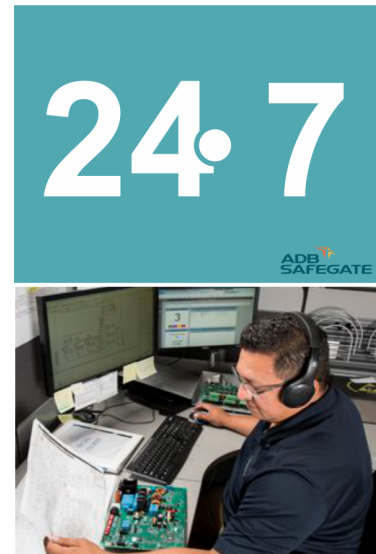

Note

For more information, see www.adbsafegate.com, or contact ADB SAFEGATE Support via email at support@adbsafegate.com or

Brussels: +32 2 722 17 11

Rest of Europe: +46 (0) 40 699 17 40

Americas: +1 614 861 1304. Press 3 for technical service or press 4 for sales support.

China: +86 (10) 8476 0106

A.1 ADB SAFEGATE Website

The ADB SAFEGATE website, www.adbsafegate.com, offers information regarding our airport solutions, products, company, news, links, downloads, references, contacts and more.

A.2 Recycling

A.2.1 Local Authority Recycling

The disposal of ADB SAFEGATE products is to be made at an applicable collection point for the recycling of electrical and electronic equipment. The correct disposal of equipment prevents any potential negative consequences for the environment and human health, which could otherwise be caused by inappropriate waste handling. The recycling of materials helps to conserve natural resources. For more detailed information about recycling of products, contact your local authority city office.

A.2.2 ADB SAFEGATE Recycling

ADB SAFEGATE is fully committed to environmentally-conscious manufacturing with strict monitoring of our own processes as well as supplier components and sub-contractor operations. ADB SAFEGATE offers a recycling program for our products to all customers worldwide, whether or not the products were sold within the EU.

ADB SAFEGATE products and/or specific electrical and electronic component parts which are fully removed/separated from any customer equipment and returned will be accepted for our recycling program.

All items returned must be clearly labelled as follows:

- For *ROHS/WEEE* Recycling
- Sender contact information (Name, Business Address, Phone number).
- Main Unit Serial Number.

ADB SAFEGATE will continue to monitor and update according for any future requirements for *EU directives* as and when *EU member states* implement new *regulations* and or *amendments*. It is our aim to maintain our *compliance plan* and assist our customers.

Company Addresses

ADB SAFEGATE	ADB SAFEGATE, Belgium: Leuvensesteenweg 585, B-1930 Zaventem Belgium
Contact: Tel.: +32 2 722 17 11, Fax: +32 2 722 17 64	Email: marketing@adbsafegate.com Internet: www.adbsafegate.com
Americas LLC	ADB SAFEGATE, Americas: 977 Gahanna Parkway, Columbus, OH 43230 USA
Contact: Tel.: +1 (614) 861 1304, Fax: +1 (614) 864 2069	Email: sales.us@adbsafegate.com Internet: www.adbsafegate.com
ADB SAFEGATE Sweden AB	ADB SAFEGATE, Sweden: Djurhagegatan 19 SE-213 76 Malmö Sweden
Contact: Tel.: +46 (0)40 699 17 00, Fax: +46 (0)40 699 17 30	Email: marketing@adbsafegate.com Internet: www.adbsafegate.com
ADB SAFEGATE Airfield Technologies Ltd. China	ADB SAFEGATE, China: Unit 603, D Block, CAMIC International Convention Center, No 3, Hua Jia Di East road, ChaoYang district, Beijing 100102 P.R. China
Contact: Tel.: +86 (10) 8476 0106, Fax: +86 (10) 8476 0090	Email: china@safegate.com Internet: www.adbsafegate.com
ADB SAFEGATE Germany GmbH	ADB SAFEGATE Germany GmbH, Mannheim: Konrad-Zuse-Ring 6, D-68163 Mannheim Germany
Contact: Tel.: +49 (621) 87 55 76-0, Fax: +49 (621) 87 55 76-55	Email: marketing@adbsafegate.com Internet: www.adbsafegate.com



**Powering Your Airport Performance
from Approach to Departure**

adbsafegate.com

Copyright © ADB SAFEGATE, all rights reserved

