



L-850 A/B LED IRCL and TDZL

## Spare Parts

SP\_3004, Rev. A, 2020/04/30

  
**ADB  
SAFEGATE**



## A.0 Disclaimer / Standard Warranty

### CE certification

The equipment listed as CE certified means that the product complies with the essential requirements concerning safety and hygiene. The European directives that have been taken into consideration in the design are available on written request to ADB SAFEGATE.

### ETL certification

The equipment listed as ETL certified means that the product complies with the essential requirements concerning safety and FAA Airfield regulations. The FAA directives that have been taken into consideration in the design are available on written request to ADB SAFEGATE.

### All Products Guarantee

ADB SAFEGATE will correct by repair or replacement per the applicable guarantee above, at its option, equipment or parts which fail because of mechanical, electrical or physical defects, provided that the goods have been properly handled and stored prior to installation, properly installed and properly operated after installation, and provided further that Buyer gives ADB SAFEGATE written notice of such defects after delivery of the goods to Buyer. Refer to the Safety section for more information on Material Handling Precautions and Storage precautions that must be followed.

ADB SAFEGATE reserves the right to examine goods upon which a claim is made. Said goods must be presented in the same condition as when the defect therein was discovered. ADB SAFEGATE further reserves the right to require the return of such goods to establish any claim.

ADB SAFEGATE's obligation under this guarantee is limited to making repair or replacement within a reasonable time after receipt of such written notice and does not include any other costs such as the cost of removal of defective part, installation of repaired product, labor or consequential damages of any kind, the exclusive remedy being to require such new parts to be furnished.

ADB SAFEGATE's liability under no circumstances will exceed the contract price of goods claimed to be defective. Any returns under this guarantee are to be on a transportation charges prepaid basis. For products not manufactured by, but sold by ADB SAFEGATE, warranty is limited to that extended by the original manufacturer. This is ADB SAFEGATE's sole guarantee and warranty with respect to the goods; there are no express warranties or warranties of fitness for any particular purpose or any implied warranties of fitness for any particular purpose or any implied warranties other than those made expressly herein. All such warranties being expressly disclaimed.

### Standard Products Guarantee

Products of ADB SAFEGATE manufacture are guaranteed against mechanical, electrical, and physical defects (excluding lamps) which may occur during proper and normal use for a period of two years from the date of ex-works delivery, and are guaranteed to be merchantable and fit for the ordinary purposes for which such products are made.



#### Note

See your sales order contract for a complete warranty description.

### FAA Certified product installed in the United States or in US Military installations guarantee

ADB SAFEGATE L858 Airfield Guidance Signs are warranted against mechanical and physical defects in design or manufacture for a period of 2 years from date of installation, per FAA AC 150/5345-44 (applicable edition).

ADB SAFEGATE L858(L) Airfield Guidance Signs are warranted against electrical defects in design or manufacture of the LED or LED specific circuitry for a period of 4 years from date of installation, per FAA EB67 (applicable edition).

ADB SAFEGATE LED light fixtures (with the exception of obstruction lighting) are warranted against electrical defects in design or manufacture of the LED or LED specific circuitry for a period of 4 years from date of installation, per FAA EB67 (applicable edition).



## Note

See your sales order contract for a complete warranty description.

---

## Liability

---



### WARNING

Use of the equipment in ways other than described in the catalog leaflet and the manual may result in personal injury, death, or property and equipment damage. Use this equipment only as described in the manual.

---

ADB SAFEGATE cannot be held responsible for injuries or damages resulting from non-standard, unintended uses of its equipment. The equipment is designed and intended only for the purpose described in the manual. Uses not described in the manual are considered unintended uses and may result in serious personal injury, death or property damage.

Unintended uses, includes the following actions:

- Making changes to equipment that have not been recommended or described in this manual or using parts that are not genuine ADB SAFEGATE replacement parts or accessories.
- Failing to make sure that auxiliary equipment complies with approval agency requirements, local codes, and all applicable safety standards if not in contradiction with the general rules.
- Using materials or auxiliary equipment that are inappropriate or incompatible with your ADB SAFEGATE equipment.
- Allowing unskilled personnel to perform any task on or with the equipment.

## © ADB SAFEGATE BV

This manual or parts thereof may not be reproduced, stored in a retrieval system, or transmitted, in any form or by any means, electronic, mechanical, photocopying, recording, nor otherwise, without ADB SAFEGATE BV's prior written consent.

This manual could contain technical inaccuracies or typographical errors. ADB SAFEGATE BV reserves the right to revise this manual from time to time in the contents thereof without obligation of ADB SAFEGATE BV to notify any person of such revision or change. Details and values given in this manual are average values and have been compiled with care. They are not binding, however, and ADB SAFEGATE BV disclaims any liability for damages or detriments suffered as a result of reliance on the information given herein or the use of products, processes or equipment to which this manual refers. No warranty is made that the use of the information or of the products, processes or equipment to which this manual refers will not infringe any third party's patents or rights. The information given does not release the buyer from making their own experiments and tests.

# TABLE OF CONTENTS

<b>1.0 Safety</b> .....	<b>1</b>
1.1 Safety Messages .....	1
1.1.1 Introduction to Safety .....	2
1.1.2 Intended Use .....	2
1.1.3 Material Handling Precautions: Storage .....	3
<b>2.0 Introduction</b> .....	<b>5</b>
2.1 L-850A Style 3 LED Runway Centerline - IRCL .....	5
2.1.1 LED In-Pavement Runway Centerline Light .....	5
2.2 L-850B Style 3 LED Touchdown Zone Light - TDZL .....	8
2.2.1 LED Runway Touchdown Zone Light .....	8
<b>3.0 Parts</b> .....	<b>11</b>
3.1 IRCL-L Parts .....	11
3.1.1 IRCL Assemblies .....	12
3.2 TDZL-L Parts .....	13
3.2.1 TDZL Assemblies .....	14
3.3 IRCL / TDZL Top Cover Assembly .....	17
<b>A.0 SUPPORT</b> .....	<b>21</b>
A.1 ADB SAFEGATE Website .....	21
A.2 Recycling .....	22
A.2.1 Local Authority Recycling .....	22
A.2.2 ADB SAFEGATE Recycling .....	22



# 1.0 Safety

## Introduction to Safety

This section contains general safety instructions for installing and using ADB SAFEGATE equipment. Some safety instructions may not apply to the equipment in this manual. Task- and equipment-specific warnings are included in other sections of this manual where appropriate.

## 1.1 Safety Messages

### HAZARD Icons used in the manual

For all HAZARD symbols in use, see the Safety section. All symbols must comply with ISO and ANSI standards.

Carefully read and observe all safety instructions in this manual, which alert you to safety hazards and conditions that may result in personal injury, death or property and equipment damage and are accompanied by the symbol shown below.



**WARNING**

Failure to observe a warning may result in personal injury, death or equipment damage.



**DANGER - Risk of electrical shock or ARC FLASH**

Disconnect equipment from line voltage. Failure to observe this warning may result in personal injury, death, or equipment damage. ARC Flash may cause blindness, severe burns or death.



**WARNING - Wear personal protective equipment**

Failure to observe may result in serious injury.



**WARNING - Do not touch**

Failure to observe this warning may result in personal injury, death, or equipment damage.



**CAUTION**

Failure to observe a caution may result in equipment damage.

### Qualified Personnel



**Important Information**

The term **qualified personnel** is defined here as individuals who thoroughly understand the equipment and its safe operation, maintenance and repair. Qualified personnel are physically capable of performing the required tasks, familiar with all relevant safety rules and regulations and have been trained to safely install, operate, maintain and repair the equipment. It is the responsibility of the company operating this equipment to ensure that its personnel meet these requirements.

Always use required personal protective equipment (PPE) and follow safe electrical work practice.

### 1.1.1 Introduction to Safety



## CAUTION

### Unsafe Equipment Use

This equipment may contain electrostatic devices, hazardous voltages and sharp edges on components

- Read installation instructions in their entirety before starting installation.
- Become familiar with the general safety instructions in this section of the manual before installing, operating, maintaining or repairing this equipment.
- Read and carefully follow the instructions throughout this manual for performing specific tasks and working with specific equipment.
- Make this manual available to personnel installing, operating, maintaining or repairing this equipment.
- Follow all applicable safety procedures required by your company, industry standards and government or other regulatory agencies.
- Install all electrical connections to local code.
- Use only electrical wire of sufficient gauge and insulation to handle the rated current demand. All wiring must meet local codes.
- Route electrical wiring along a protected path. Make sure they will not be damaged by moving equipment.
- Protect components from damage, wear, and harsh environment conditions.
- Allow ample room for maintenance, panel accessibility, and cover removal.
- Protect equipment with safety devices as specified by applicable safety regulations
- If safety devices must be removed for installation, install them immediately after the work is completed and check them for proper functioning prior to returning power to the circuit.

**Failure to follow this instruction can result in serious injury or equipment damage**

### Additional Reference Materials



#### Important Information

- IEC - International Standards and Conformity Assessment for all electrical, electronic and related technologies.
- IEC 60364 - Electrical Installations in Buildings.
- FAA Advisory: AC 150/5340-26 (current edition), Maintenance of Airport Visual Aid Facilities.
- Maintenance personnel must refer to the maintenance procedure described in the ICAO Airport Services Manual, Part 9.
- ANSI/NFPA 79, Electrical Standards for Metalworking Machine Tools.
- National and local electrical codes and standards.

### 1.1.2 Intended Use



## CAUTION

### Use this equipment as intended by the manufacturer

This equipment is designed to perform a specific function, do not use this equipment for other purposes

- Using this equipment in ways other than described in this manual may result in personal injury, death or property and equipment damage. Use this equipment only as described in this manual.

**Failure to follow this instruction can result in serious injury or equipment damage**



### 1.1.3 Material Handling Precautions: Storage



#### CAUTION

##### **Improper Storage**

Store this equipment properly

- If equipment is to be stored prior to installation, it must be protected from the weather and kept free of condensation and dust.

**Failure to follow this instruction can result in equipment damage**



## 2.0 Introduction

This section provides an introduction to the:

- L-850A(L) Style 3 LED Runway Centerline -- IRCL Inpavement Light Fixtures.
- L-850B(L) Style 3 LED Touchdown Zone Light -- TDZL Inpavement Light Fixtures.

### 2.1 L-850A Style 3 LED Runway Centerline - IRCL



#### 2.1.1 LED In-Pavement Runway Centerline Light

##### Compliance with Standards

FAA:	L-850A(L) AC 150/5345-46 (Current Edition) and the FAA Engineering Brief No. 67.
ICAO:	Annex 14, Vol. 1, par. 5.3.12 and Appendix 2, Figure A2-7
T/C:	Transport Canada TP 312 par. 5.3.13
CE:	Complies with the requirements of the EMC Directive 2004/108/EC

##### Uses

###### FAA L-850A(L) ICAO & T/C

- Runway centerline on category I, II, and III runway

##### Features

- Average LED life of 56,000 hours under high-intensity conditions and more than 150,000 hours under typical operating conditions, which significantly reduces ongoing maintenance costs and periodic re-lamping expenses, resulting in lower life cycle cost
- For white runway centerline applications, use of LED light source eliminates color shifts at lower CCR step settings. For red runway centerline applications, use of LED light source eliminates filter replacement and color shifts when viewed at various angles or CCR step settings.
- FAA Style 3—Low protrusion above ground of  $\leq 0.25$  inch reduces vibrations caused by aircraft landing gear increasing lamp life
- Can be installed on existing 6.6 A or 20 A series circuits with no modifications to existing CCR or isolation transformer
- Operates on either 3- or 5-step ferroresonant or thyristor CCRs that are designed in compliance with IEC or FAA requirements
- Very low power rating for LED lights contributes to a lower life cycle cost. Limits cost for supporting equipment, such as CCRs, to strict minimum.
- When quartz-incandescent fixtures are replaced with LED fixtures, airport staff can add more lights without increasing CCR size
- Smart electronics control current to LED, so light output matches existing incandescent fixtures.
- Smart electronics allow for a low cost and progressive evolution of the airfield lighting toward new LED-based technology.

## Introduction

- LED photometric performance will be maintained longer due to a cleaner lens. Lower lens temperature prevents the “baking effect” that causes contaminants to stick to the lens surface.
- Rugged lightning protection complies with ANSI/IEEE C62.41-1991 Location Category C2 given in FAA Eng. Brief 67. Category C2 is defined as a 1.2/50µS – 8/20 µS combination wave, with a peak voltage of 10,000 V and a peak current of 5,000 A.
- Light channel in front of prism windows protects prisms from damage and prevents rubber buildup thereby maintaining optimal light output
- Includes a UL 467 rated ground lug, which accepts an AWG 6 earth ground wire
- Environment-friendly, precision-cast aluminum alloy cover, optical support, and inner cover assembly with stainless steel hardware

## Electrical Supply

It is recommended that the L-850A(L) LED fixture be powered from a dedicated CCR and that separate remote controls are available. IRCL LED lights have been designed to work with any IEC- or FAA-compliant transformer up to 200 W without affecting the performance or lifetime of the light fixture or transformer. See data sheet 3033 for more details on recommended isolation transformers (XF) specified below.

L-850A(L)	Fixture Load	Isol. XF	Isol. XF Load	CCR Load
<b>Without Heater</b>				
Unidirectional	15 VA	20/25 W	6 VA	21 VA
Bidirectional <sup>1</sup>	29 VA	30/45 W	6 VA	35 VA
Bidirectional <sup>2</sup>	25 VA per side (50 VA total)	20/25 W per side	7.5 VA per XF	32.5 VA per side (65 VA total)
<b>With Heater</b>				
Unidirectional	30 VA	30/45 W	6 VA	36 VA
Bidirectional <sup>1</sup>	59 VA	65 W	13 VA	74 VA
Bidirectional <sup>2</sup>	41 VA per side (82 VA total)	30/45 W per side	9 VA per XF	50 VA per side (100 VA total)

### Notes

<sup>1</sup> One cord set

<sup>2</sup> One cord set per side (2 total)

## Operating Conditions

Temperature:	-40 °C to +55 °C (-40 °F to +131 °F)
Altitude:	Sea level to 10,000 feet (3000 m)
Relative Humidity:	Up to 100%

## Dimensions: Single Cord Set / FAA

Outside diameter:	11.94 in (30.33 cm)
Bolt-circle diameter (L-868B):	11.25 in (28.58 cm)
Bottom cover depth:	3.88 in (9.9 cm)

## Dimensions: Two Cord Set / FAA, ICAO, & TP 312

Outside Diameter:	11.94 in (30.33 cm)
Bolt Circle Diameter (L-868B):	11.25 in (28.58 cm)
Max. Bottom Cover O.D.:	9.94 in (25.25 cm)
Bottom Cover Depth:	3.8 in (9.65 cm) *

### Notes

\* If used in conjunction with an L-868B Top Section, the overall height of the Top Section must be 4 in (10.16 cm) minimum.

## Packaging

In cardboard box:	7 × 13 × 13 in (17.8 × 33 × 33 cm)
Weight with packing:	17 lb (7.71 kg)
Weight without packing:	13.75 lb (6.24 kg)

## FAA Photometric Data

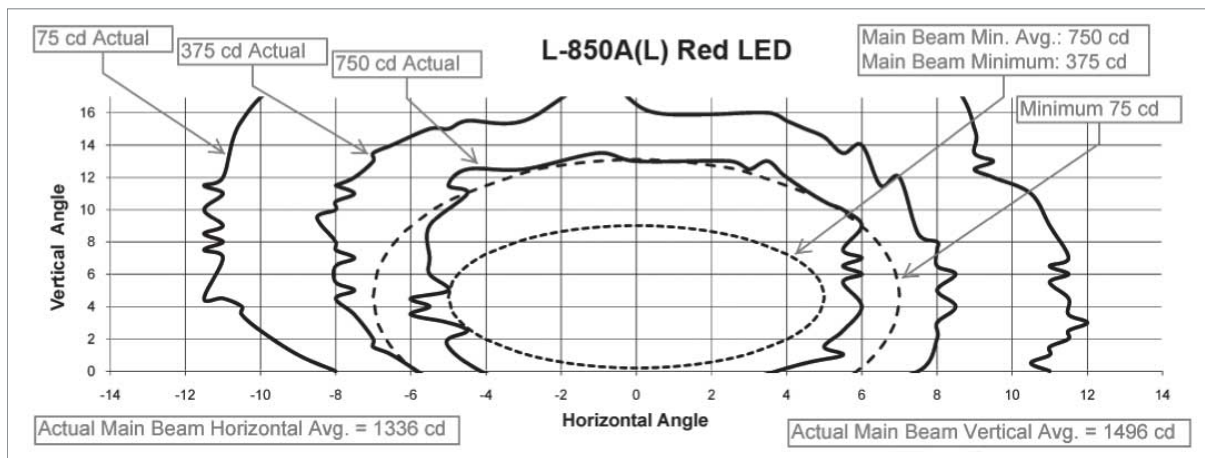
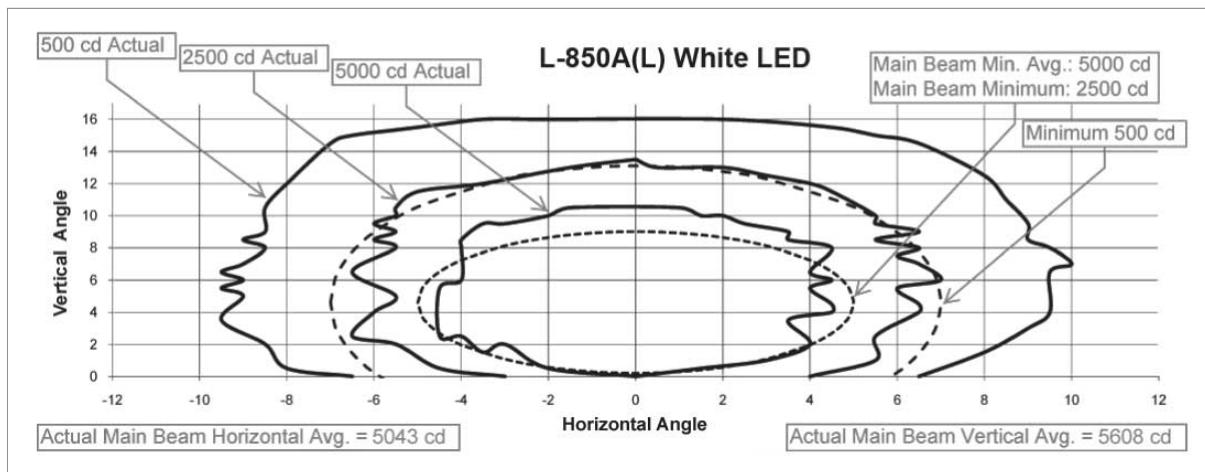

## 2.2 L-850B Style 3 LED Touchdown Zone Light - TDZL



### 2.2.1 LED Runway Touchdown Zone Light

#### Compliance with Standards

FAA:	L-850B(L) AC 150/5345-46 (Current Edition) and the FAA Engineering Brief No. 67.
ICAO:	Annex 14, Vol. 1, par. 5.3.13 and Appendix 2, Figure A2-5.
T/C:	Transport Canada TP 312 par. 5.3.14.
CE:	Complies with the requirements of the EMC Directive 2004/108/EC.

#### Uses

##### FAA L-850B(L) ICAO & T/C

- Touchdown zone lighting on category II and III runways

#### Features

- Average LED life of 56,000 hours under high-intensity conditions and more than 150,000 hours under typical operating conditions, which significantly reduces ongoing maintenance costs and periodic re-lamping expenses, resulting in lower life cycle cost
- Use of LED light source eliminates color shifts at lower CCR step settings
- FAA Style 3—Low protrusion above ground of  $\leq 0.25$  inch reduces vibrations caused by aircraft landing gear in both the light fixture and the landing gear, increasing lamp life
- Can be installed on existing 6.6 A or 20 A series circuits with no modifications to existing CCR or isolation transformer
- Operates on either 3- or 5-step ferroresonant or thyristor CCRs that are designed in compliance with IEC or FAA requirements
- Very low power rating for LED lights contributes to a lower life cycle cost. Limits cost for supporting equipment, such as CCRs, to strict minimum.
- When quartz-incandescent fixtures are replaced with LED fixtures, airport staff can add more lights without increasing CCR size
- Smart electronics control current to LED, so light output matches existing incandescent fixtures.
- Smart electronics allow for a low cost and progressive evolution of the airfield lighting toward new LED-based technology.
- LED photometric performance will be maintained longer due to a cleaner lens. Lower lens temperature prevents the "baking effect" that causes contaminants to stick to the lens surface.
- Rugged lightning protection complies with ANSI/IEEE C62.41-1991 Location Category C2 given in FAA Eng. Brief 67. Category C2 is defined as a 1.2/50 $\mu$ S – 8/20  $\mu$ S combination wave, with a peak voltage of 10,000 V and a peak current of 5,000 A.
- Light channel in front of prism windows protects prisms from damage and prevents rubber buildup thereby maintaining optimal light output
- Includes a UL 467 rated ground lug, which accepts an AWG 6 earth ground wire
- Environment-friendly, precision-cast aluminum alloy cover, optical support, and inner cover assembly with stainless steel hardware

## Operating Conditions

Temperature:	-40 °C to +55 °C (-40 °F to +131 °F)
Altitude:	Sea level to 10,000 feet (3000 m)
Relative Humidity:	Up to 100%

## Electrical Supply

It is recommended that the L-850B(L) LED fixture be powered from a dedicated CCR and that separate remote controls are available. TDZL LED lights have been designed to work with any IEC- or FAA-compliant transformer up to 100 W without affecting the performance or lifetime of the light fixture or transformer. See data sheet 3033 for more details on recommended isolation transformers specified below.

L-850B(L)	Fixture Load	Isolation Transformer	Isol. XF Load	CCR Load
W/out heater	15 VA	20/25 W	6 VA	21 VA
W/out heater	15 VA	30/45 W	9 VA	24 VA
With heater	30 VA	30/45 W	6 VA	36 VA

## Touchdown Zone Toe-in Coding

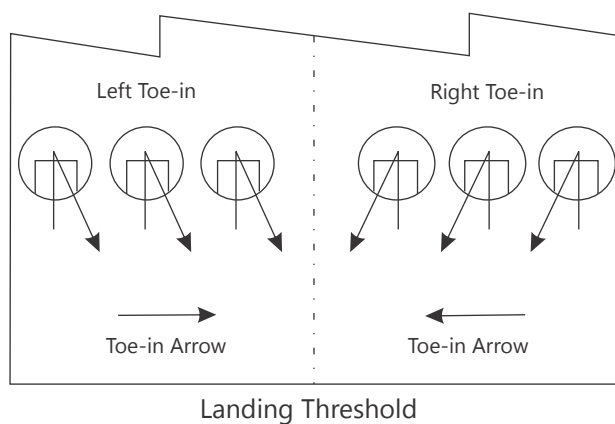

## Packaging

In cardboard box:	7 × 13 × 13 in (17.8 × 33 × 33 cm)
Weight with packing:	16.5 lb (7.48 kg)
Weight without packing:	13.25 lb (6 kg)

## Dimensions: FAA / ICAO - Configuration 1

Outside diameter:	11.94 in (30.33 cm)
Bolt-circle diameter (L-868B):	11.25 in (28.58 cm)
Max. Bottom Cover O.D.:	6.25 in (15.88 cm)
Bottom Cover Depth:	3.88 in (9.9 cm)

## Dimensions: ICAO - Configuration 2

---

Outside Diameter:	11.94 in (30.33 cm)
Bolt Circle Diameter (L-868B):	11.25 in (28.58 cm)
Max. Bottom Cover O.D.:	
- 9.94 in (25.20 cm) down to depth of 1.63 in (4.14 cm)	
- 8.69 in (22.00 cm) from depth of 1.63 in (4.14 cm) to 3.88 in (9.86 cm)	
Bottom Cover Depth:	3.88 in (9.9 cm)

---

## FAA Photometric Data

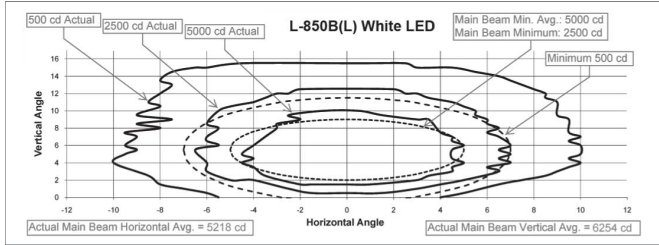



## 3.0 Parts

This section provides parts information for the L-850A and the L-850 B, LED Style 3 light fixtures.

### 3.1 IRCL-L Parts

#### Ordering Code

##### LED Colors

- 1 = White/White
- 2 = White/Red
- 3 = Red/Red
- 4 = White/Obscure
- 5 = Red/Obscure
- 7 = Yellow/Obscure

##### Monitoring

- 1 = No monitoring

##### Frequency

- 1 = 60 Hz
- 2 = 50 Hz<sup>1</sup>

##### Cord Set

- 1 = One<sup>1</sup>
- 2 = Two<sup>2</sup>

##### Arctic Option

- 1 = No<sup>1</sup>
- 2 = Yes

##### Specification

- 0 = FAA<sup>1</sup>
- 1 = ICAO<sup>1</sup>
- 3 = FAA with heavy-duty abrasion-resistant lens coating<sup>3,4</sup>
- 4 = ICAO with heavy-duty abrasion-resistant lens coating<sup>3,4</sup>

##### Notes

- <sup>1</sup> L-850A(L) LED 50 Hz without heater using a single cord set carries the CE Mark
- <sup>2</sup> See Dimensions section for 2 cord set specs
- <sup>3</sup> Typically used for intensive winter service where sand is applied to runways and rotating brushes are used.
- <sup>4</sup> Not ETL Certified.

IRCL - X X X X X

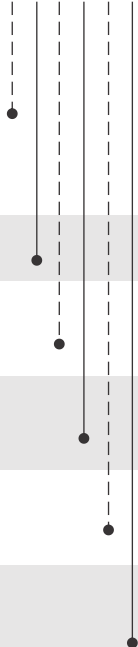

**Table 1: IRCL Common Spare Components**

Description	Part No.
Cable clamp	4071.50.090
Cord set, dual	4072.24.950
Cord set, L-823, single (jacket)	44A7387-10
Cord set grommet, single	63A1014
Cord set terminal, female, single	70A0329
LED light engine, L-850A(L), red (FAA & ICAO)	48A0419-RED
LED light engine, L-850A(L), white (FAA & ICAO)	48A0419-WHT
LED PCB, single cord set, white/white	44A7257-5
LED PCB, single cord set, white/red and white/obscure	44A7257-4
LED PCB, single cord set, red/red	44A7257-1
LED PCB, single cord set, red/obscure	44A7257-2

**Table 1: IRCL Common Spare Components (continued)**

Description	Part No.
LED PCB, dual cord set	44A7228-00200
O-ring, bottom cover seal	63A1285
O-ring, pressure release screw	63B0267-011
Pressure release screw	60A2602
Prism	63A1119-1
Prism gasket sleeve	61A0444
Prism clamp	60A4046
Prism flat seal	63A1120
Prism keeper plate	60A4047

**Table 2: Past IRCL-L Light Engines**

LED light engine, L-850A, red (FAA) (pre-2015 units)	48A0405-RED
LED light engine, L-850A, white (FAA) (pre-2015 units)	48A0405-WHT

### 3.1.1 IRCL Assemblies

**Table 3: IRCL-L Assemblies**

IRCL Assembly	Subassembly Part Numbers	Subassembly Description
IRCL/XXXXXX	44A6975/XXX	Bottom Cover Assembly
	44A6871/XXXXX	IRCL, Top Cover
	44A7223/XXXXX	Interm. Bottom Pan Assy

## 3.2 TDZL-L Parts

### Ordering Code

#### Light Beam

- 1 = Straight
- 2 = Toe-in Right
- 3 = Toe-in Left

#### Monitoring

- 1 = No monitoring

#### Frequency

- 1 = 60 Hz
- 2 = 50 Hz<sup>1</sup>

#### Arctic Option

- 1 = No<sup>1</sup>
- 2 = Yes

#### Specification

- 0 = FAA Configuration 1<sup>2</sup>
- 2 = ICAO Configuration 2<sup>3</sup>
- 3 = FAA with heavy-duty abrasion-resistant lens coating<sup>4,5</sup>
- 4 = ICAO with heavy-duty abrasion-resistant lens coating<sup>4,5</sup>

#### Notes

- <sup>1</sup> L-850B(L) LED 50 Hz without heater carries the CE Mark
- <sup>2</sup> Comes with smaller bottom cover and standard 2-pin FAA L-823 connector
- <sup>3</sup> Comes with intermediate size bottom cover and 2-pin FAA L-823 connector. Cord set can be easily replaced without opening fixture.
- <sup>4</sup> Typically used for intensive winter service where sand is applied to runways and rotating brushes are used.
- <sup>5</sup> Not ETL Certified.

TDZL- X X X X X

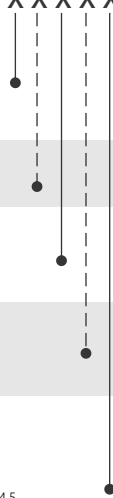

**Table 4: TDZL Common Spare Components**

Description	Part No.
Cable clamp	4071.50.090
Cord set, L-823 (jacket)	44A7387-10
Cord set grommet	63A1014
Cord set terminal, female	70A0329
LED light engine, L-850B(L), white (FAA & ICAO)	48A0419-WHT
LED PCB, white	44A7257-3
O-ring, bottom cover seal	63A1285
O-ring, pressure release screw	63B0267-011
Pressure release screw	60A2602
Prism	63A1119-1
Prism gasket sleeve	61A0444
Prism clamp	60A4046
Prism flat seal	63A1120
Prism keeper plate	60A4047

**Table 5: Past TDZL-L Light Engine**

LED light engine, L-850A, white (FAA) (pre-2015 units)	48A0405-WHT
--	-------------

### 3.2.1 TDZL Assemblies

**Table 6: TDZL-L Assemblies**

TDZL Assembly	Subassembly Part Numbers	Subassembly Description
TDZL/XXXXX	44A6975/310	Bottom Pan Assy Current 5 LED 600ma STL 6 CORD
	44A6871/XXXXX	IRCL/TDZL TOP COVER
	44A7223/11100	Interm. Pan Assy,1CD,50/60HZ,Single Driver, No Monitoring

#### 3.2.1.1 Intermediate Bottom Pan Assembly

44A7223/XXXXX

**Figure 1: Intermediate Bottom Pan Assembly Diagram**

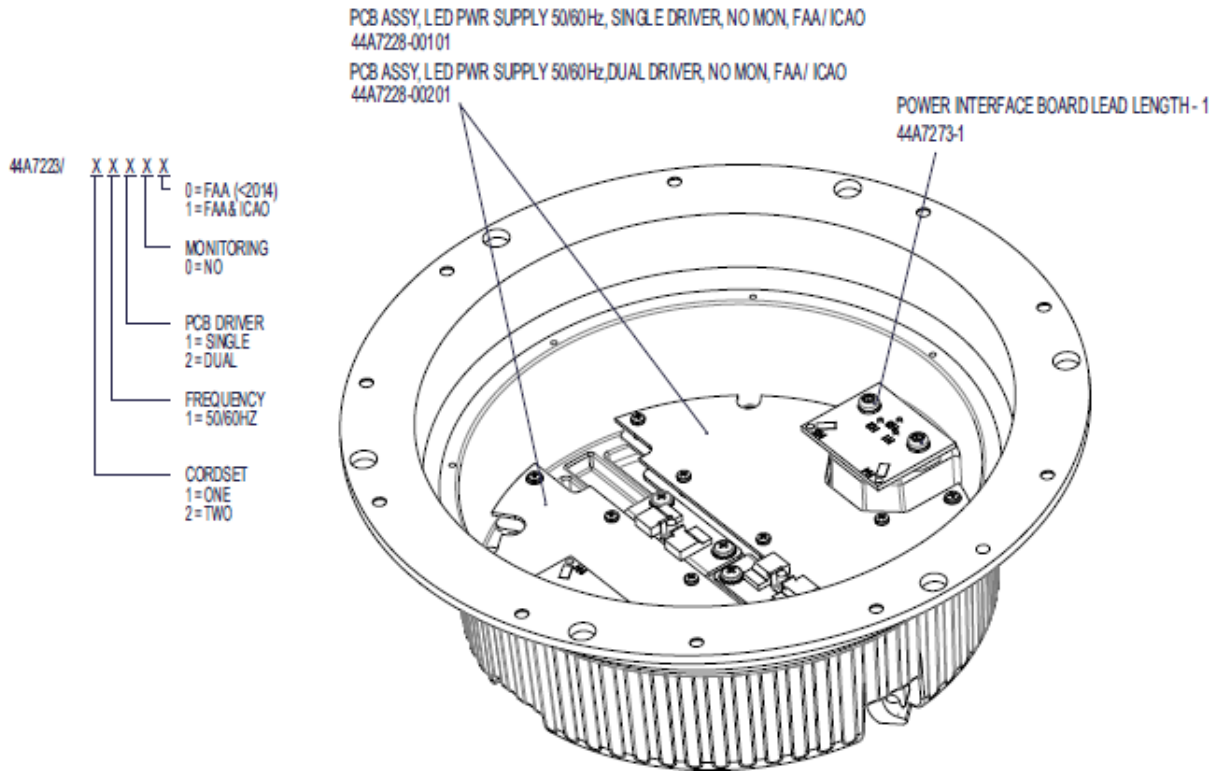

**Table 7: Intermediate Bottom Pan Assembly Parts**

Part Number	Description
44A7228-00101	Interm Pan PCB Assy 50/60Hz,Single Driver, No Monitoring
44A7228-00201	Interm Pan PCB Assy 50/60Hz, Dual Driver, No Monitoring
44A7273-1	Power Interface PCB Lead Length-1
60A2602	Pressure Relief Screw
63B0267-011	O RING Pressure Relief Screw
72A0401	Alum Grnd Lug, for AL/CU & UL467
4072.42.380	Cord Cable Clamp
4072.42.351	Cord 2 Conductor 18"

Figure 2: 44A7228/XXXXX

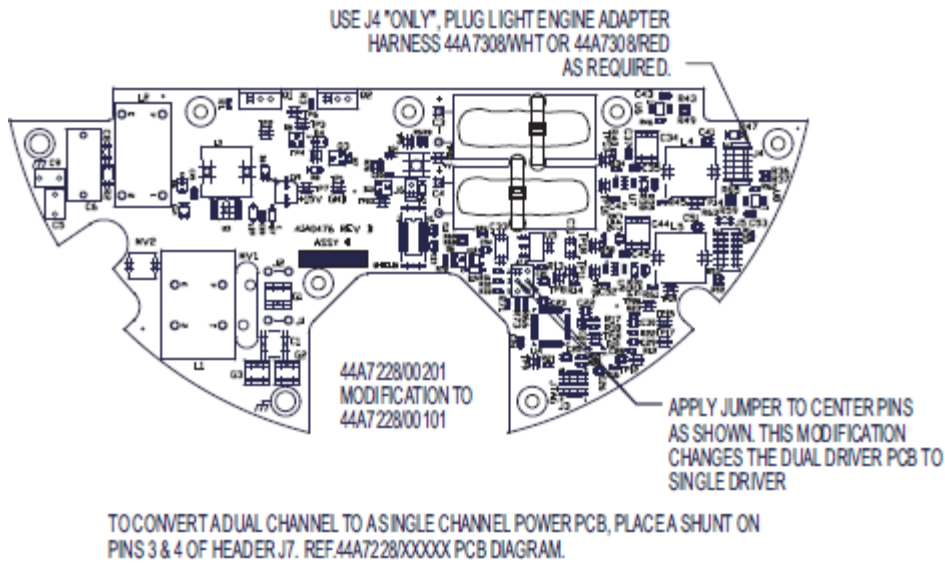

3.2.1.2 Deep Small Bottom Pan Assembly

44A6975/XXX

**Figure 3: Small Deep Bottom Pan Assembly Diagram**

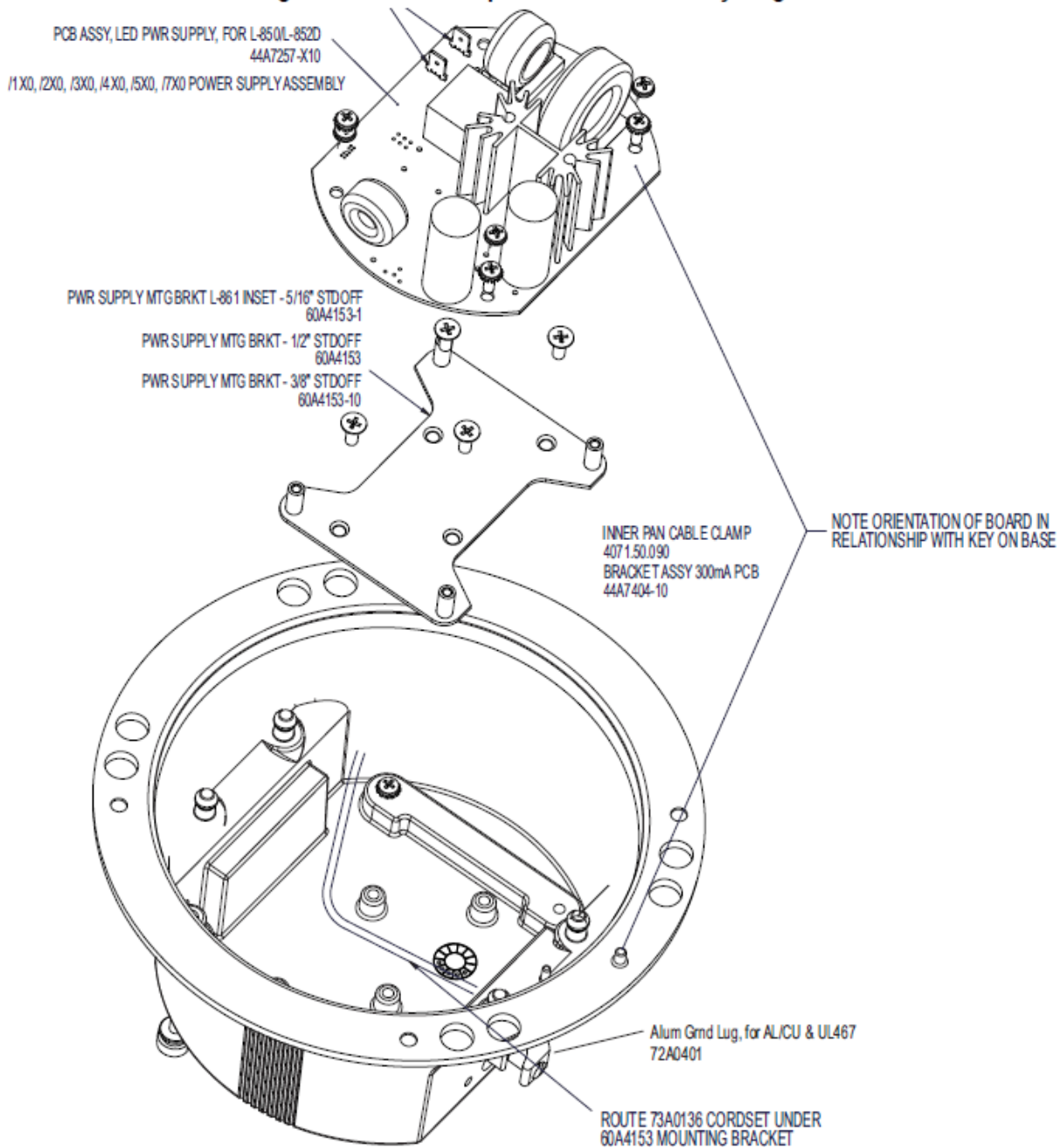

**Table 8: Small Deep Bottom Pan Assembly Parts**

Part Number	Description
44A7257-3	PCB PS ASSY, L850/L852D, 600mA,
60A2602	Pressure Relief Screw
60A3339-1	44A6738 1 Cord W/O Monitoring (NO MACH REQ)
60A4153-10	Pwr Supply MTG Bracket L-861 INSET 3/8"

**Table 8: Small Deep Bottom Pan Assembly Parts (continued)**

Part Number	Description
63B0267-011	O-Ring for Pressure Relief Screw
70A0329	FEM DISC 16-14AWG .25X.03 INS
44A7387-10	Cord Set Over-mold Style 1

**Figure 4: 44A7387-10 Cordset**

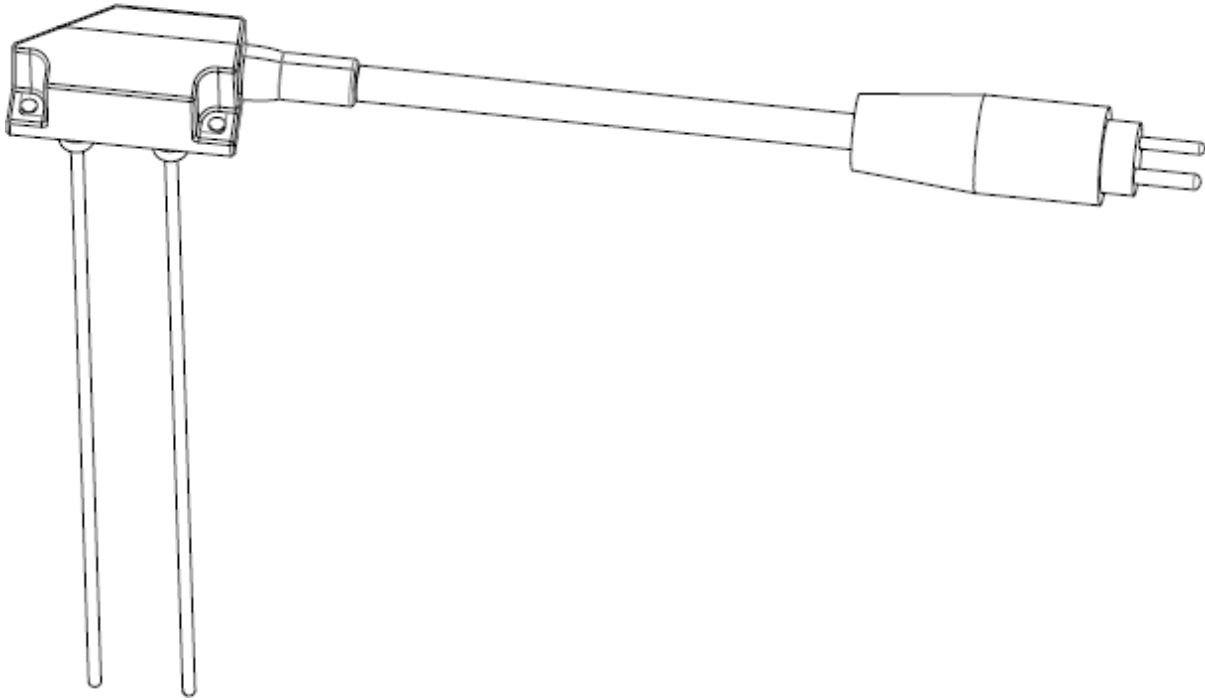

### 3.3 IRCL / TDZL Top Cover Assembly

**Figure 5: L850x, 44A6871**

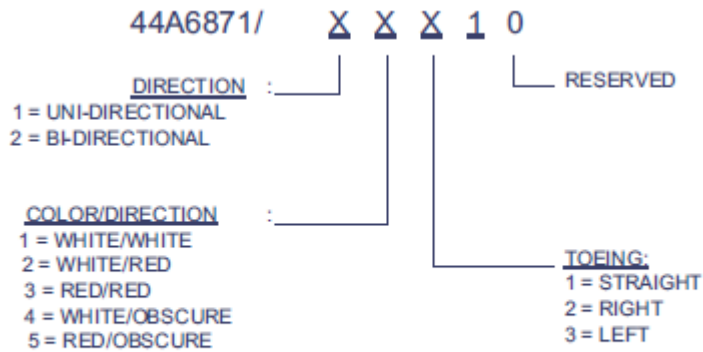

**Figure 6: IRCL / TDZL Assembly (IRCL-L Bi directional Assembly Shown)**

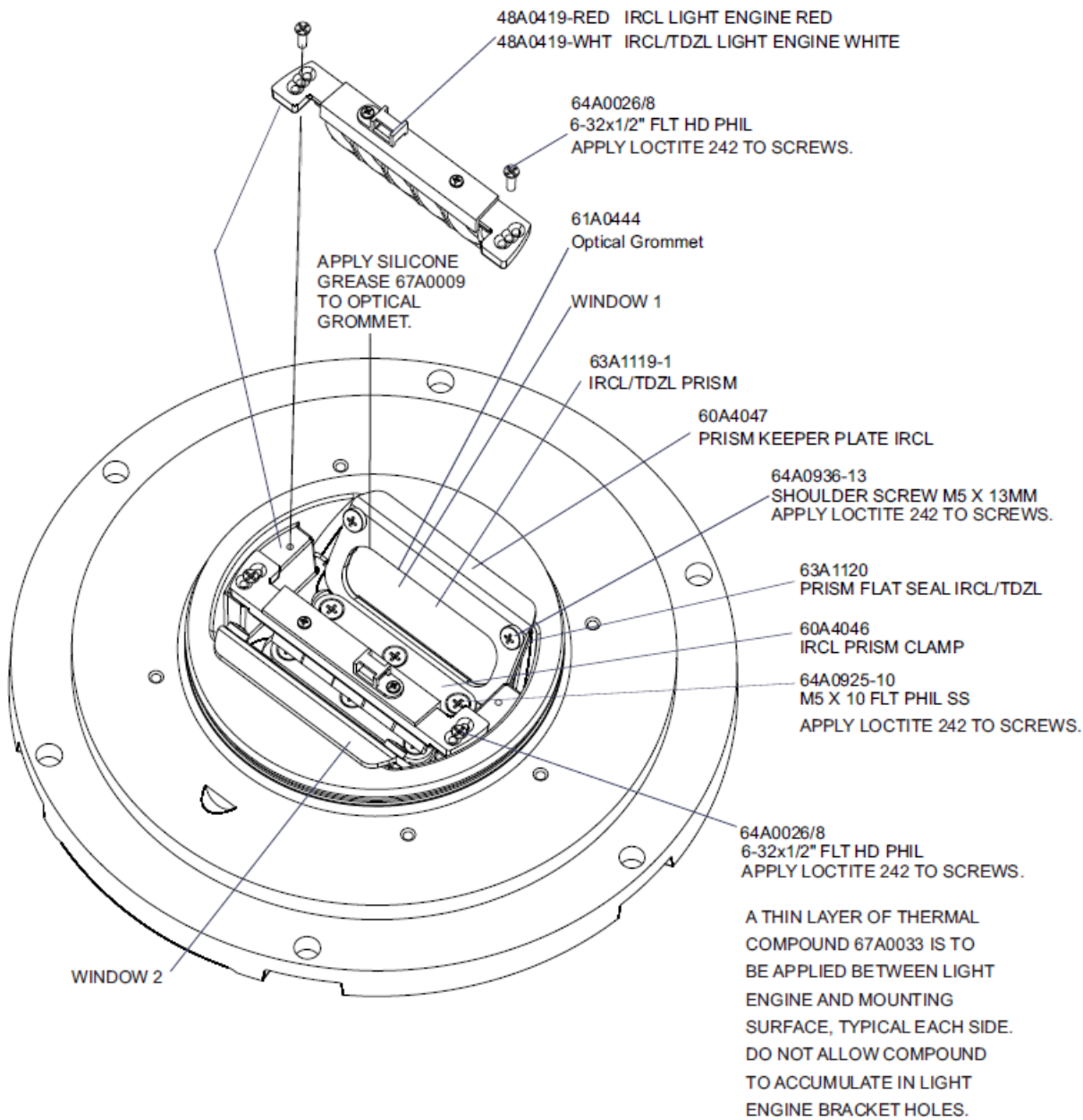

**Table 9: IRCL / TDZL Top Cover and Prism Assembly Parts**

Part Number	Description
48A0419-WHT	IRCL ICAO/THL LIGHT ENGINE, WHT
48A0419-RED	IRCL FAA LIGHT ENGINE, RED
48A0405-WHT	IRCL LED LIGHT ENGINE, WHT (OBS)
48A0405-RED	IRCL LED LIGHT ENGINE, RED (OBS)
60A406	PRISM CLAMP IRCL
60A407	PRISM KEEPER PLATE IRCL
61A0444	IRCL PRISM SOCK SEAL
62A2187-1	IRCL/TDZL TOP COVER MACHINING 1 WINDOW
63A1120	PRISM SEAL IRCL



**Table 9: IRCL / TDZL Top Cover and Prism Assembly Parts (continued)**

Part Number	Description
63A1119-1	IRCL/TDZL PRISM
63A1285	O-RING F-RANGE FIXTURES
61A0459	HEATER DISC, 2 LEADS W/Terminals

**Figure 7: IRCL / TDZL Top Cover and Prism Assembly**

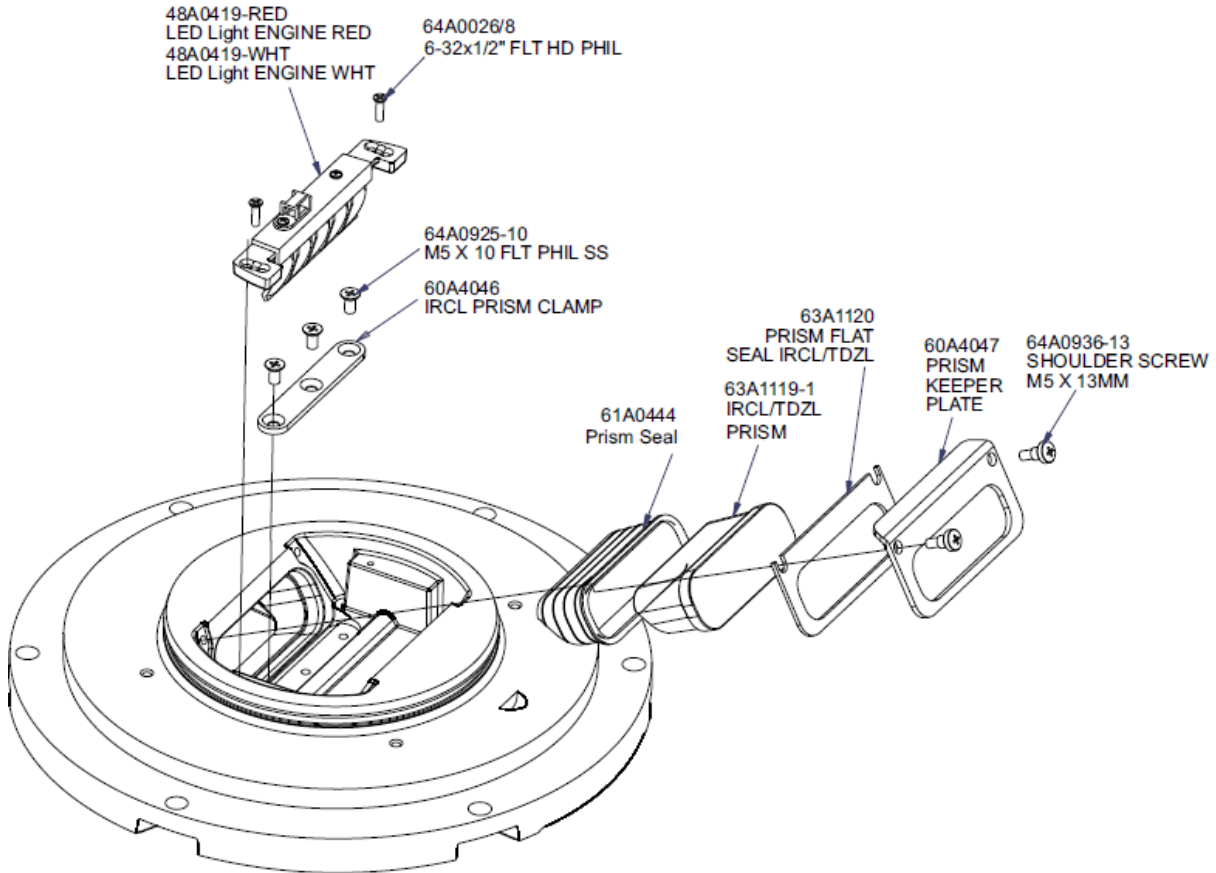

**Figure 8: TDZL Right and Left Toe Alignment of LED Assembly**

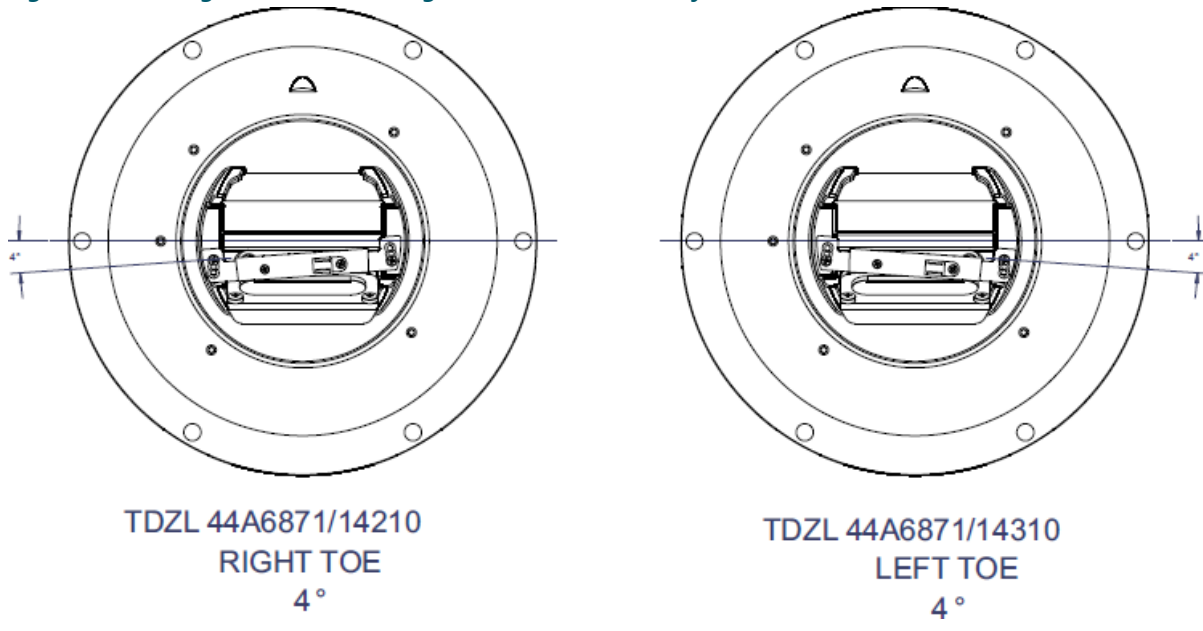

## Appendix A: SUPPORT

Our experienced engineers are available for support and service at all times, 24 hour/7 days a week. They are part of a dynamic organization making sure the entire ADB SAFEGATE is committed to minimal disturbance for airport operations.

### ADB SAFEGATE Support

#### Live Technical Support - Americas

If at any time you have a question or concern about your product, just contact ADB SAFEGATE's technical service department. Trained in all areas of system issues, troubleshooting, quality control and technical assistance, our highly experienced Technical support specialists are available 24 hours a day, seven days a week to provide assistance over the phone.

ADB SAFEGATE **Americas Technical Service & Support (US & Canada): +1-800-545-4157**

**ADB SAFEGATE Americas Technical Service & Support (International): +1-614-861-1304**

During regular business hours, you can also Chat with a Service Technician. We look forward to working with you!

#### Before You Call

When you have an airfield lighting or system control system problem it is our goal to support airfield maintenance staff as quickly as possible. To support this effort we ask that you have the following information ready before calling.

- The *airport code*
- If not with an airport, then company name (prefer customer id number)
- Contact phone number and email address
- Product with part number preferable or product number
- Have you reviewed the product's manual and troubleshooting guide
- Do you have a *True RMS* meter available (and any other necessary tools)
- Be located with the product ready to troubleshoot

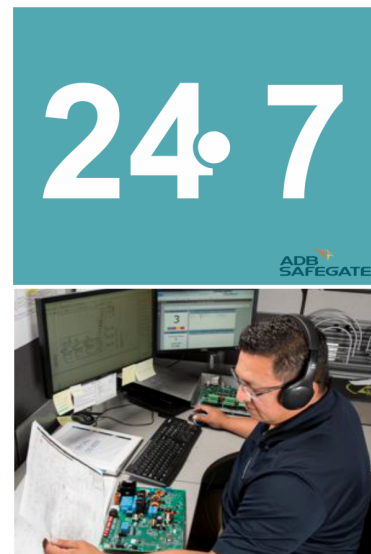

#### Note

For more information, see [www.adbsafegate.com](http://www.adbsafegate.com), or contact ADB SAFEGATE Support via email at [support@adbsafegate.com](mailto:support@adbsafegate.com) or

Brussels: +32 2 722 17 11

Rest of Europe: +46 (0) 40 699 17 40

Americas: +1 614 861 1304. Press 3 for technical service or press 4 for sales support.

China: +86 (10) 8476 0106

### A.1 ADB SAFEGATE Website

The ADB SAFEGATE website, [www.adbsafegate.com](http://www.adbsafegate.com), offers information regarding our airport solutions, products, company, news, links, downloads, references, contacts and more.

## A.2 Recycling

### A.2.1 Local Authority Recycling

The disposal of ADB SAFEGATE products is to be made at an applicable collection point for the recycling of electrical and electronic equipment. The correct disposal of equipment prevents any potential negative consequences for the environment and human health, which could otherwise be caused by inappropriate waste handling. The recycling of materials helps to conserve natural resources. For more detailed information about recycling of products, contact your local authority city office.

### A.2.2 ADB SAFEGATE Recycling

ADB SAFEGATE is fully committed to environmentally-conscious manufacturing with strict monitoring of our own processes as well as supplier components and sub-contractor operations. ADB SAFEGATE offers a recycling program for our products to all customers worldwide, whether or not the products were sold within the EU.

ADB SAFEGATE products and/or specific electrical and electronic component parts which are fully removed/separated from any customer equipment and returned will be accepted for our recycling program.

All items returned must be clearly labelled as follows:

- For *ROHS/WEEE* Recycling
- Sender contact information (Name, Business Address, Phone number).
- Main Unit Serial Number.

ADB SAFEGATE will continue to monitor and update according for any future requirements for *EU directives* as and when *EU member states* implement new *regulations* and or *amendments*. It is our aim to maintain our *compliance plan* and assist our customers.

## Company Addresses

ADB SAFEGATE	ADB SAFEGATE, Belgium: Leuvensesteenweg 585, B-1930 Zaventem Belgium
Contact: Tel.: +32 2 722 17 11, Fax: +32 2 722 17 64	Email: <a href="mailto:marketing@adbsafegate.com">marketing@adbsafegate.com</a> Internet: <a href="http://www.adbsafegate.com">www.adbsafegate.com</a>
Americas LLC	ADB SAFEGATE, Americas: 977 Gahanna Parkway, Columbus, OH 43230 USA
Contact: Tel.: +1 (614) 861 1304, Fax: +1 (614) 864 2069	Email: <a href="mailto:sales.us@adbsafegate.com">sales.us@adbsafegate.com</a> Internet: <a href="http://www.adbsafegate.com">www.adbsafegate.com</a>
ADB SAFEGATE Sweden AB	ADB SAFEGATE, Sweden: Djurhagegatan 19 SE-213 76 Malmö Sweden
Contact: Tel.: +46 (0)40 699 17 00, Fax: +46 (0)40 699 17 30	Email: <a href="mailto:marketing@adbsafegate.com">marketing@adbsafegate.com</a> Internet: <a href="http://www.adbsafegate.com">www.adbsafegate.com</a>
ADB SAFEGATE Airfield Technologies Ltd. China	ADB SAFEGATE, China: Unit 603, D Block, CAMIC International Convention Center, No 3, Hua Jia Di East road, ChaoYang district, Beijing 100102 P.R. China
Contact: Tel.: +86 (10) 8476 0106, Fax: +86 (10) 8476 0090	Email: <a href="mailto:china@safegate.com">china@safegate.com</a> Internet: <a href="http://www.adbsafegate.com">www.adbsafegate.com</a>
ADB SAFEGATE Germany GmbH	ADB SAFEGATE Germany GmbH, Mannheim: Konrad-Zuse-Ring 6, D-68163 Mannheim Germany
Contact: Tel.: +49 (621) 87 55 76-0, Fax: +49 (621) 87 55 76-55	Email: <a href="mailto:marketing@adbsafegate.com">marketing@adbsafegate.com</a> Internet: <a href="http://www.adbsafegate.com">www.adbsafegate.com</a>



## Powering Your Airport Performance from Approach to Departure

[adbsafegate.com](https://adbsafegate.com)

Copyright © ADB SAFEGATE, all rights reserved

