

FAA L-868 BASE

LIGHT DETAIL NOTES:

1. LIGHT BASES SHALL BE INSTALLED WITH CARE TO ASSURE VERTICAL & AZIMUTH ALIGNMENT OF FIXTURE.
2. PROVIDE 2'-3" (600-900mm) CABLE SLACK WITHIN LIGHT BASE TO ALLOW TRANSFORMER SERVICING.
3. REFER TO FAA ENGINEERING BRIEF 83 (LATEST REVISION) FOR RECOMMENDED INSTALLATION REQUIREMENTS INCLUDING BOLT, WASHER, AND TORQUE GUIDANCE.
4. AS REQUIRED TO MAINTAIN $+0/-1/16"$ ($+0, -1.5\text{mm}$) BELOW GRADE FAA INSTALLATION TOLERANCE. A MAXIMUM OF THREE SPACER RINGS MAY BE STACKED TOGETHER, INCLUDING THE FLANGE RING.
5. ADB SAFEGATE PART DRCXXXXXX OR DTZXXXXXX.

CAUTION:
THIS DRAWING IS ONLY INTENDED FOR USE AS GENERAL AIRFIELD SYSTEM DESIGN GUIDANCE. THE DESIGNER MUST VERIFY DESIGN WITH LOCAL CODES AND VARYING CHARACTERISTICS FOR EACH UNIQUE AIRFIELD APPLICATION.

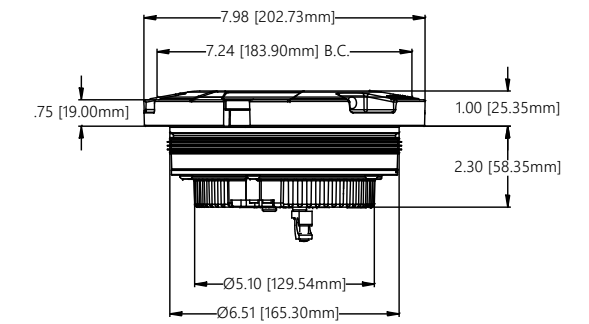

REFERENCE DIMENSIONS

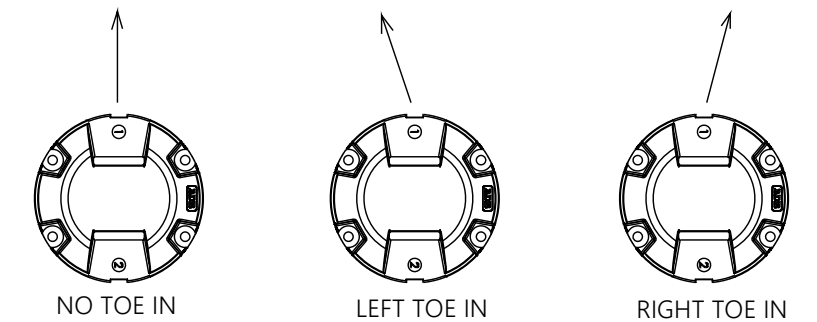

DTZ TOW DIRECTION

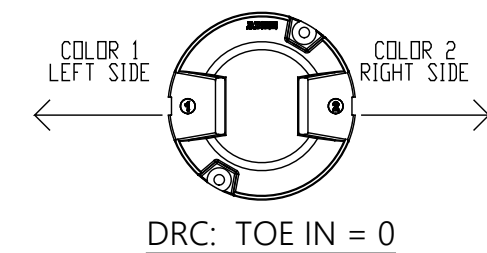

DRC: TOE IN = 0

CONTROLLED COPY			
Unauthorized duplication of this document in whole or part is prohibited. Initialed in RED ink below indicates authorized copy.			
INITIAL & DATE: _____			
P.O. Box 30829 Tel: (614) 861-1304 977 Gahanna Parkway Fax: (614) 864-2069 Columbus, OH 43230			
D	270	REFER EB 83	JEG 12JUN19
C	4228	CHG TORQUE VALUE & BOLT	DLR 1MAR16
B	---	PRODUCTION RELEASE	DLR 16MAR15
A	---	INITIAL RELEASE	DLR 9MAR15
REV LEVEL	ECO NUMBER	REVISION DESCRIPTION	DRAWN BY REV DATE
ASSOCIATED DRAWINGS:		DRAWN BY: D RUFFINI	DRAWN DATE: 9MAR15
Information contained on this drawing is to be used expressly in accord with purpose for which it was submitted. Any disclosure of this information is strictly prohibited except as ADB SAFEGATE, Inc. may otherwise agree in writing. Copyright © 2010 ADB SAFEGATE.			
SCALE: N/A		SHEET NUMBER: 1 OF 3	
DRAWING NUMBER: 117A0091			REV: D