

Taxiway Lighting

EL-EAM

Omnidirectional Medium-/Low-Intensity Elevated Light



Compliance with Standards

ICAO: Annex 14 Volume I (Current Edition)

FAA: AC 150/5345-46D, L-861, L-861T

IEC: 61827

NATO: STANAG 3316

BS 3224 Part 4

STAC

CAP 168

Uses

EL-EAM is an omnidirectional (medium/low intensity) elevated light. This fixture has following application areas:

- Taxiway Edge
- Apron Edge
- Runway Approach (low intensity)
- Runway Threshold (low intensity)
- Runway End (low intensity)
- Runway Edge (low intensity)

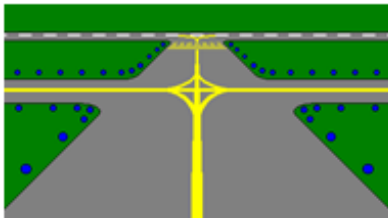

Features & Benefits

- Low power consumption, only 45 Watts
- Lamp life greater than 1,500 hours at 6.6 Amps
- Resistance to jet blast, complying with IEC standards
- Frangibility of the fitting complying with FAA and IEC standards
- Quick lamp replacement by unscrewing the glass dome
- Power supply cable protected by running through the support

- Easy adjustment by means three Allen screws locking onto the adjustable body
- Simple but sturdy design
- Lightweight, less than 1.5 kg with the lamp

Technical characteristics

Component	Description
Lamp:	45 W pre-focused halogen Pk30d socket. The lamp life is greater than 1,500 hours at 6.6 Amps.
Power Supply:	By 2 × 2.5 mm ² two pole- FAA- type plug connection to one transformer.
Photometry:	The distribution complies with ICAO Annex 14 Volume I and with FAA L861 and L861T.
Color:	Obtained by full colored glass dome. The chromaticity complies with Appendix 1 of ICAO Annex 14 Volume I.
Finish:	The body levelling and the support are made of aluminium alloy casting, phosphate and painted in aviation yellow by an electrostatic process (powder coating). The body is made of polyamide and fibreglass. All fixings and fastenings are stainless steel.
Fixing on support:	Fixing on support (tripod stand, elbow tube or base plate) using the 2" NPS, 2" BSP or 1.5" UNF thread below the frangible part of the fitting.
Adjustment:	Horizontal adjustment using three sets of Allen screws.
Height:	310 mm.
Net Weight:	Less than 1.5 kg with the lamp.

Taxiway Lighting

EL-EAM

Photometrics

This section includes photometric examples of light configurations.

Photometric examples:

Blue light
ICAO Taxiway Edge
FAA L-861-T

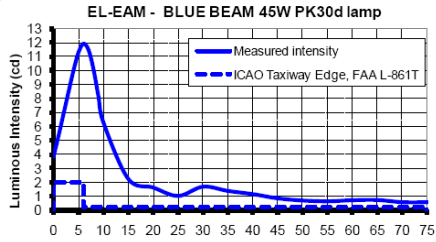

Red light
FAA L-861

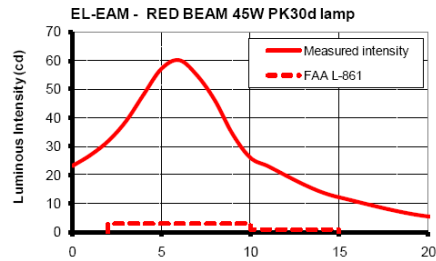

White light
FAA L-861

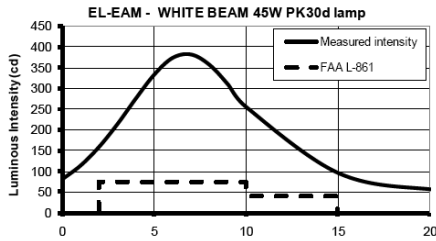

Yellow light
FAA L-861

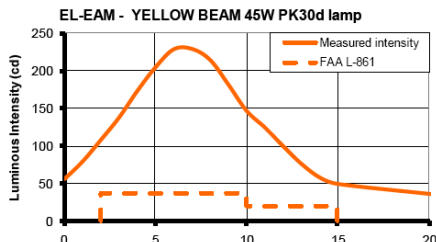

Green light
FAA L-861

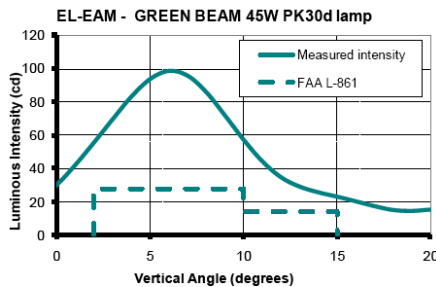

Design

Components

1. Optical Glass with Fresnel Prism
2. Pk30d 45W
3. Lamp holder
4. Cable Terminal
5. Mounting with screws
6. Gasket
7. Body Allowing Levelling
8. Setting Allen Screws
9. Frangible Leg Support
10. Two Pole Cables with FAA Secondary Plug.

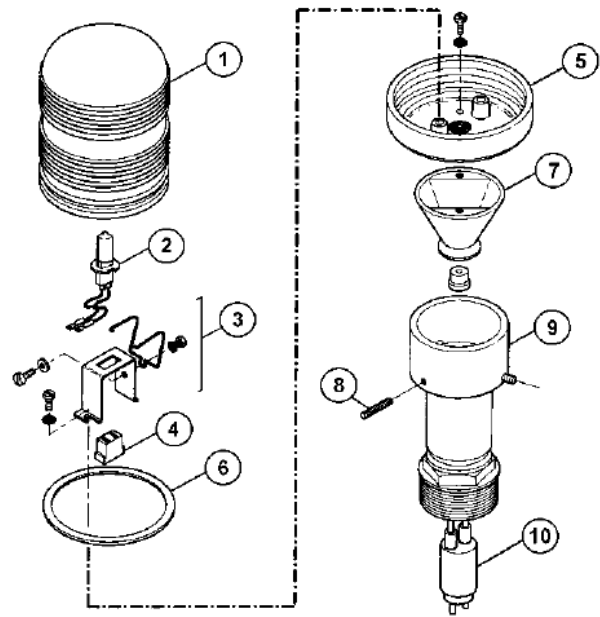

EL-EAM

Installation

EL-EAM can be installed:

- On a tripod stand, see Fig. 1
- On conduit elbow, see Fig. 2
- on FAA deep can and base plate, see Fig. 3

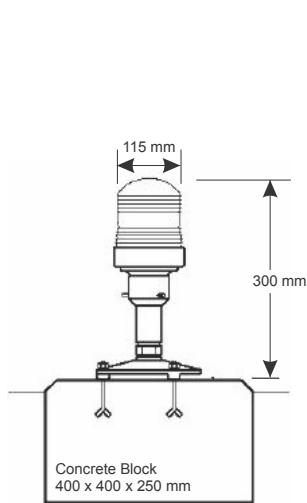

Fig. 1: Bolted to concrete

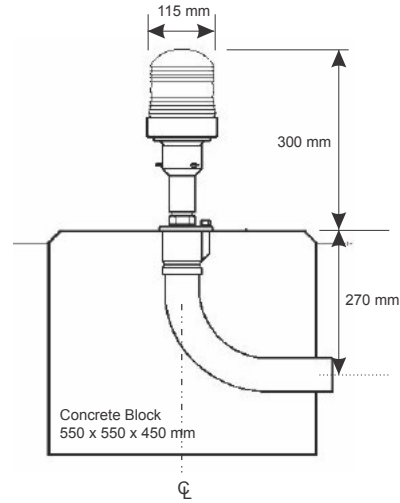

Fig. 2: Mounted on conduit

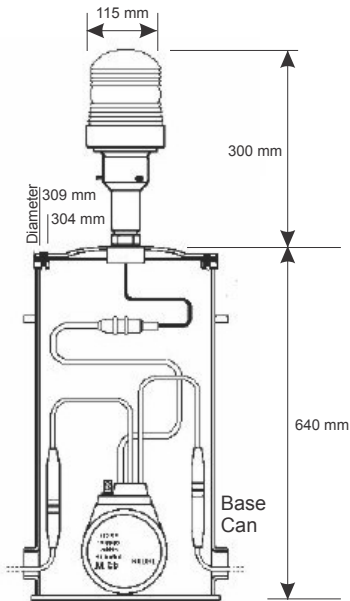

Fig.3: Mounted on base can

Taxiway Lighting

EL-EAM

Order codes

The table below is a guide to order codes for a fitting with available component parts.

Description	Component
EL-EAM 2 " NPS with connector EL-EAM 2 " NPS without connector EL-EAM 2 " BSP with connector EL-EAM 2 " BSP without connector EL-EAM 1.5 " UNF with connector EL-EAM 1.5 " UNF without connector	EL-EAM NPS+CONN EL-EAM NPS EL-EAM BSP+CONN EL-EAM BSP EL-EAM UNF+CONN EL-EAM UNF
45 W Pk30d Lamp	Pk30d / 45 W
One color (360°) glass dome	
<ul style="list-style-type: none">• Blue (Taxiway edge)• White (MI runway approach or edge)• Green (LI runway threshold)• Red (LI runway end)• Yellow (MI runway edge)	EL-EAM/FILTER/B EL-EAM/FILTER/W EL-EAM/FILTER/G EL-EAM/FILTER/R EL-EAM/FILTER/Y
Two colors (on 180°) glass dome	
<ul style="list-style-type: none">• Green/Red (LI runway end and threshold)• White/Green• White /Red• White /Yellow• Red/ Yellow	EL-EAM/FILTER/R/G EL-EAM/FILTER/W/G EL-EAM/FILTER/W/R EL-EAM/FILTER/W/Y EL-EAM/FILTER/R/Y
180° blank screen	EL-EAM/BLANK_SCREEN
FITTING SUPPORTS	See www.adbsafegate.com
SETTING TOOL	EL-EAM/SETTING TOOL
DAY MARKING CONE	EL-EAM/DAY_MARKING_CONE

Note: All descriptions and photometric characteristics in this publication present only general particulars and shall not form part of any contract. The right is reserved to change them without prior notification.

www.adbsafegate.com

Product specifications may be subject to change, and specifications listed here are not binding. Confirm current specifications at time of order.