

# HELIPORT LIGHTING

## F2.1

### Omnidirectional Elevated Light



#### Compliance with Standards

- ICAO:** Annex 14 Volume II (Current Edition)
- FAA:** AC 150/5390-2B
- NATO:** STANAG 3652; 3619
- STAC:** French
- BS:** 3224

#### Uses

F2.1 is an omnidirectional elevated light. This fixture has following application areas:

- FATO: Final Approach and Take Off area
- TLOF: Touchdown and Lift Off area
- Heliport Approach
- Taxiway Edge
- Apron Edge

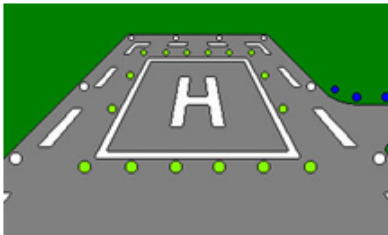

#### Features & Benefits

- Low power consumption
- Power supply: 230 VAC 50/60 Hz or 6.6 A
- Lifetime higher than 2,000 hours for halogen lamps
- Frangible support
- Easy and fast lamp replacement
- Power Supply Cable protected by running through the support
- Simple but sturdy design
- Light weight: Less than 1.5 kg with the lamp
- The fittings installed on frangible holding tubes can be equipped in option with a day marking cone

#### Technical Characteristics

Component	Description
<b>Lamp:</b>	E27 Halogen lamp of 105 W maximum. Lifetime higher than 2,000 hours, (8,000 hours for obstruction). G Y 6.35 lamp for Heliport Approach 12 V system.
<b>Power Supply:</b>	230 VAC, through a 2x1.5 mm <sup>2</sup> cable or 6.6 A.
<b>Photometry and colors:</b>	Compliant with ICAO Annex 14 volume II and volume I Appendix 1.
<b>Finish:</b>	Yellow full colored body in polyamide reinforced with glass. Mounting accessories in aluminum. All fixings and fastening in stainless steel.
<b>Overall height:</b>	250 mm (short frangible tube), 340 mm (long frangible tube), from 350 mm to 1.8 m (pole with frangible coupling), above 1.8 m (tiltable mast).
<b>IP:</b>	34
<b>Class:</b>	2

# HELIPORT LIGHTING

## F2.1

### Installation

- Ground level mounting on long frangible tube (Fig 1)
- Ground level mounting on short frangible tube (Fig 2)
- Up to 1.8 m on a pole with frangible coupling (Fig 3)
- Above 1.8 m on a tillable mast.
- On any other safety support with 60 mm external diameter

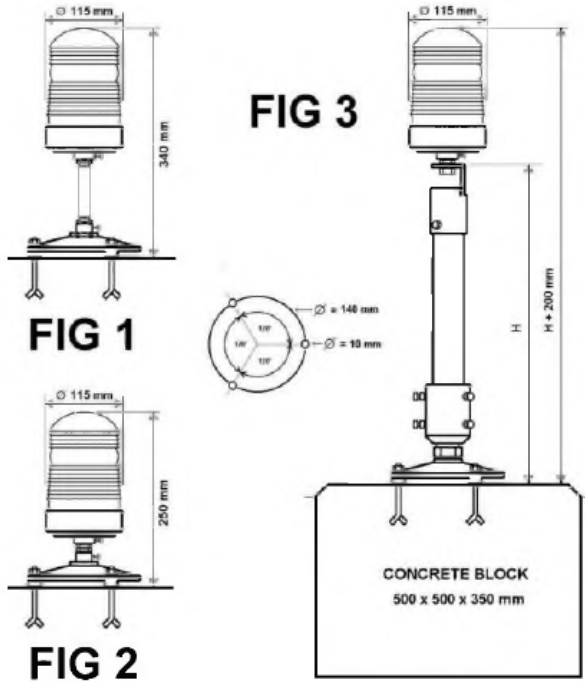

For more information about the product, including manuals and certifications, please see our Product Center on the ADB Safegate website: [www.adbsafegate.com](http://www.adbsafegate.com).

### Design

Components	F2.1
1/2/5	F2-1 unit for E27 lamp with accessories
1/3/4/5 2 3	F2-1 unit for PK30d lamp with accessories
4	E27 Lamp holder
5	PK30d lamp holder
6	PK30d cable terminal
7	Glass gasket
8	E27 230 V lamp
9	PK30d 45 W 6.6 A lamp
10	Blanking screen for E27 version
11	Blanking screen for PK30d version
12/13/14	Glass dome E27 version
12/13/15	Glass dome PK30d version
13/14	Tripod stand with short frangible tube
13/15	Tripod stand with long frangible tube
13 Nut G1/2	Short frangible tube with nuts
13 Nut G1/2	long frangible tube with nuts
-	Day marking cone (used with long frangible tube)
16	60 mm tube
17/18/19	Adapter for 60 mm tube

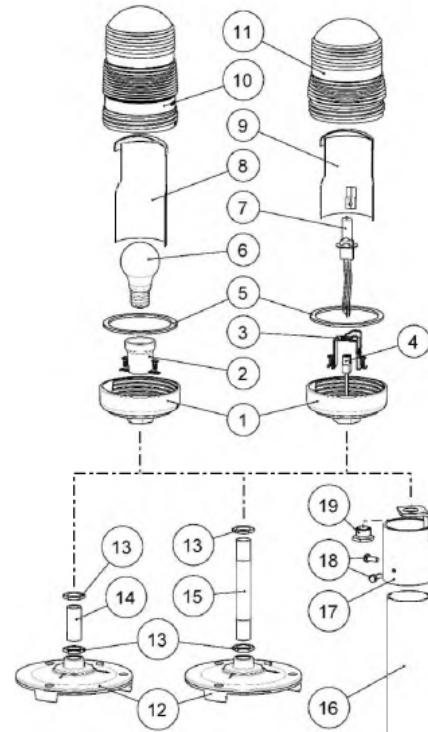

### Photometrics

This section includes photometric example of different light configurations.

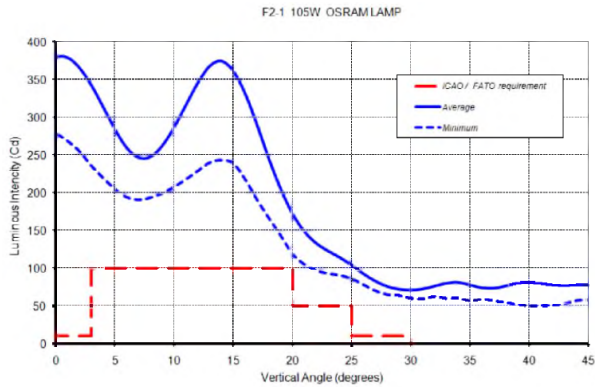

Helipad Lights FATO – White light E 27

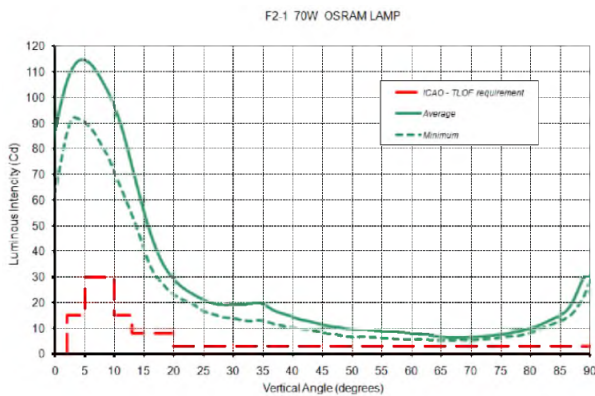

Helipad Lights TLOF – Green light E 27

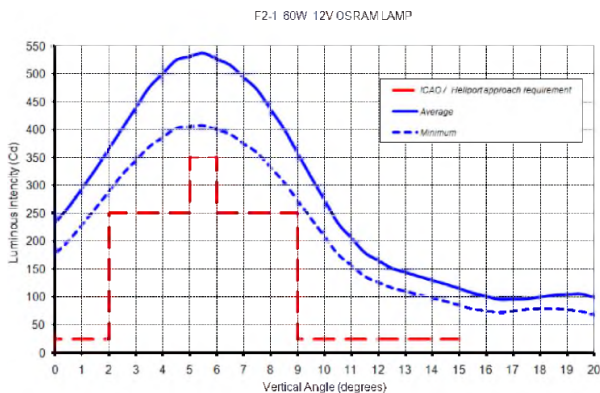

Helipad Lights, Approach - White light E 27

### Order Code

The table below is a guide to order codes for a fitting with available component parts.

F2.1 Fitting component	Order Code
F2.1 mounting for E27 lamp (without optical glass and lamp)	F2.1+E27
White optical glass dome for E27 lamp	F2.1 / FILTER / W
Green optical glass dome for E27 lamp	F2.1 / FILTER / G
Blue optical glass dome for E27 lamp	F2.1 / FILTER / B
Long frangible tube or Short frangible tube	F2.1 / LONG_FT - F2.1 / SHORT_FT
Special tripod stand for frangible tube	F2.1 / TRIPODE STAND
Frangible coupling, 60 mm tube and tripod stand	F2.1 / 60mm COUPLING
Lamp component	Order Code
E27 105 W lamp (FATO )	E27 / 105W 230V
E27 70 W lamp (TLOF, Taxiway and Apron)	E27 / 70W 230V
E27 55W 8000h lamp (Obstruction)	E27 / 55W 8000h
Day marking cone (Option) * Only for ground level mounting on frangible Tube	F2.1 / DAY_MARKING_CONE

### Packing Data

Designation	Volume m <sup>3</sup>	Dimensions mm	Weight Kg
F2.1 fitting without optical glass and without lamp	0.0125	270×240×190	0.7
Optical glass dome for E27 lamp (× 6)	0.012	520×260×200	5.4
E27 lamps (× 20)	0.007	229×107×287	0.81
Day marking cone	0.06	410×410×360	0.5

**Note:** All descriptions and photometric characteristics in this publication present only general particulars and shall not form part of any contract. The right is reserved to change them without prior notification.